

# City of Capitola

## Art & Cultural Commission

### Tuesday, October 14, 2025 – 6:30 PM

Community Room

420 Capitola Avenue, Capitola CA 95010

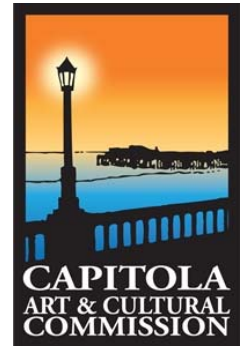

**Chair:** Mary Beth Cahalen

**Vice Chair:** Roy Johnson

**Commissioners:** Karin Anderson, Courtney Christiansen, Joe Clarke, Enrique Dolmo Jr., Roy Holmberg, Jill Lengre, Esther Sylvan.

**Staff Representatives:** Nikki Bryant

- 
1. **Call to Order**
  2. **Additional Materials**
  3. **Public Oral Communication:** *Public Oral Communication allows members of the public to address the Commission on any Program Report or topics within the purview of the Commission not on the General Business agenda.*
  4. **Commissioner Comments**
  5. **Staff Comments**
  6. **Approval of Minutes- Regular Meeting September 9, 2025.**
  7. **Program/Committee Reports:** *All items in program and committee reports are staff or committee updates. Public Communication for these items is to be addressed during Public Oral Communication.*
  8. **General Business:** *All items listed in General Business are intended to provide an opportunity for public discussion. The following procedure pertains to each General Business item 1) Staff explanation; 2) Commission Questions; 3) Public Comment; 4) Commission deliberation; 5) Decision.*
    - a. **Begonia Festival Commemorative Public Art Project:** *Receive report and provide recommendation.*
    - b. **Park at Rispin Mansion Public Art:** *Consider establishing a budget for City Council recommendation and developing a formal Call to Artist.*
    - c. **November Art & Culture Commission Meeting:** *Choose new date for November meeting due to Holiday.*
  9. **Adjournment:** *to the next regular Art & Cultural Commission meeting on TBD 2025*

*Agenda and agenda Packet Materials:* The Art and Cultural Commission Agenda is available on the City's website: [www.cityofcapitola.org](http://www.cityofcapitola.org) on Friday prior to the Tuesday meeting. If you need additional information, please contact the City Hall Department at (831) 475-7300

*American with Disabilities Act:* Disability-related aids or services are available to enable persons with a disability to participate in this meeting consistent with the Federal Americans with Disabilities Act of 1990. Assisted listening devices are available for individual with hearing impairments at the meeting in the City Council Chambers. Should you require special accommodation to participate in the meeting due to a disability, please contact the City Clerk's office at least 24-hours in advance of the meeting at (831) 475-7300. In an effort to accommodate individuals with environmental sensitivities, attendees are requested to refrain from wearing perfumes and other scented products.

*Appeals: Any person who believes that a final action of this advisory body has been taken in error may appeal that decision to the City Council. Appeals must be in writing and delivered to the City Clerk's Office within ten (10) working days from the time of the board's decision. The notice of appeal shall set forth appellant's name, phone number, address to which notices may be sent to the appellant, and the grounds upon which the appeal is made.*

# City of Capitola

## Art & Cultural Commission: Draft Minutes

### Tuesday, September 9, 2025 – 6:30 PM

Council Chambers

420 Capitola Avenue, Capitola CA 95010

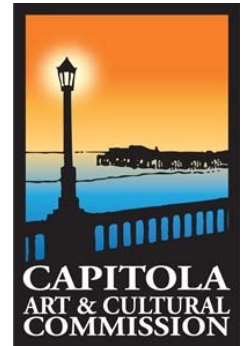

**Chair:** Mary Beth Cahalen

**Vice Chair:** Roy Johnson

**Commissioners:** Karin Anderson, Courtney Christiansen, Mayor Joe Clarke, Enrique Dolmo Jr., Roy Holmberg, Jill Lengre, Esther Sylvan

**Staff Representatives:** Nikki Bryant

---

#### 1. Call to Order:

The meeting was called to order at 6:31 PM. In attendance: Anderson, Christinsen, Cahalen, Clarke, Dolmo, Holmberg, Johnson, Lengre, Sylvan.

#### 2. Additional Materials

None

#### 3. Public Oral Communication

Carin Hanna

#### 4. Commissioner Comments

Commissioner Anderson commented on the progress of Plein Air and supports suggestions given at oral communication regarding events during non-summer months. New Music Sunday

Mayor Clarke commented on the status of the Park at Rispin Mansion and requested the reflecting pool Public Art be added to the commission agenda

Chair Cahalen commented on considering holiday events for future goal setting

Commissioner Holmberg commented on the final Makers Market

Commissioner Lengre commented on the final Makers Market

#### 5. Staff Comments

The 41<sup>st</sup> Ave Corridor Study should be presented to Council in November.

The Public Works department is in process of contracting an engineer for the technical specifications for the Weathervane project and expects the Call to Artist to be released in October.

#### 6. Approval of Minutes- August 12, 2025

Motion to approve the Minutes: Commissioner Holmberg

Second: Commissioner Lengre

Voting Yea: Commissioner Anderson, Commissioner Christinsen, Chair Cahalen, Mayor Clarke, Commissioner Dolmo, Commissioner Holmberg, Vice Chair Johnson, Commissioner Lengre, Commissioner Sylvan

#### 7. Program/Committee Reports

Plein Air notifications went out and the deadline to confirm participation is September 9, 2025.

#### 8. General Business

##### a. Former Wharf Arch

Report given by Staff. Commissioner Holmberg commented on the feasibility of previously suggested locations. The Commission discussed other potential locations and mounting requirements for the former arch. Commissioner Lengre suggested at the top of Depot Stairs. Vice Chair Johnson suggested the bottom of Depot Stairs.

Public Comment: Carin Hanna

Motion to approve staff to determine feasibility of developing a Public Art project, using the former Wharf Arch, at the top of Depot Stairs: Chair Cahalen

Second: Mayor Clarke

Voting Yea: Commissioner Anderson, Commissioner Christinsen, Chair Cahalen, Mayor Clarke, Commissioner Dolmo, Commissioner Holmberg, Vice Chair Johnson, Commissioner Lengre, Commissioner Sylvan.

**b. Village Streetlight Banners**

Report given by Staff. Vice Chair Johnson asked about the FY 24/25 budget and proposed a flag type attachment for future project. Commissioner Lengre questioned how other city manage banners. Carin Hanna, as BIA representative, provided information of the original proposal and options that had been considered in the past. Chair Cahalen commented that the BIA should continue to be included in the development of another project.

Public Comment: Carin Hanna

Motion to approve staff provide a report on the options available with the current hardware of the village streetlights and feasibility of a flag type connection: Chair Cahalen

Second: Vice Chair Johnson

Voting Yea: Commissioner Anderson, Commissioner Christinsen, Chair Cahalen, Mayor Clarke, Commissioner Dolmo, Commissioner Holmberg, Vice Chair Johnson, Commissioner Lengre, Commissioner Sylvan.

**9. Adjournment**

The meeting was adjourned at 7:29 PM to the next regular Art & Cultural Commission meeting on October 14, 2025.

ATTEST:

---

Nikki Bryant

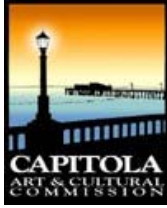

Item #: 8.a

# ART & CULTURAL COMMISSION AGENDA REPORT

## MEETING OF October 14, 2025

FROM: Staff  
DATE: September 18, 2025  
SUBJECT: Begonia Festival Commemorative Public Art Project

---

**Recommended Action:** Receive report and provide recommendation.

---

### **BACKGROUND**

In the 1950s, Capitola was recognized as the “World Begonia Capital”. The City hosted the well-known Begonia Festival, which ran from the 1950s through 2017. The last Begonia Festival was held in 2017, due to the closure of local begonia fields. In April 2018, Board Members of the Capitola Begonia Festival contacted the Art and Cultural Commission regarding the proposal of a public art project commemorating the Begonia Festival. The Begonia Festival Board (currently known as the Capitola Beach Festival) voted to donate \$20,000 to the City to be used toward a commemorative public art piece.

On September 26, 2024, the City Council authorized the City Manager to enter into an agreement with Geoffrey Nelson. The sculpture was installed in the final week of January. The “unveiling” was held on February 22, 2025.

### **DISCUSSION**

The colors of the begonia’s flowers have experienced significant fading since the installation and the commission considered the issue during the August 12, 2025, meeting. The Commission requested the artist, Geoffrey Nelson conduct research and provide a presentation on October 14, 2025, meeting. Staff communicated the request and confirmed his availability. On September 11, 2025, staff reached out to the artist after the community noticed a change in the Begonia’s coloring. The artist replied that he has reapplied paint to test the color and plans to apply a UV coating to the sculpture.

### **FISCAL IMPACT**

### **ATTACHMENT**

**Report Prepared By:** Nikki Bryant  
Director of Community Services & Recreation

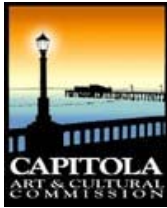

# ART & CULTURAL COMMISSION AGENDA REPORT

## MEETING OF October 14, 2025

FROM: Staff

DATE: September 23, 2025

SUBJECT: Mosaic Reflecting Pool and other Rispin Park Public Art

---

**Recommended Action** Consider establishing a budget for City Council recommendation and developing a formal Call to Artist.

### **BACKGROUND**

The City of Capitola initiated plans for a park at the Rispin Mansion site in 2014. At the time, significant community outreach and collaboration helped form the project, which included an extensive landscape design and planting plan developed by Michael Arnone and Associates. In its current iteration, the Park at Rispin Mansion Project (Park) is a multi-year effort to create a new public park on the historic Rispin Mansion property.

On July 28, 2022, the City Council approved the plans, specifications, and construction budget of the Project. A public bid opening was held on February 22, 2023; however, no construction bids were received. In response, staff reached out to potential bidders, who indicated they did not bid because the City's budget was insufficient for the scope of work. In compliance with provisions outlined in the public contract code, staff worked with a local contractor, Betz Works, to develop a feasible scope of work within the approved budget.

One feature not funded is a Public Art Mosaic Reflecting Pool. The Public Works Director submitted a grant application for the NEA's FY26 Grants for Arts Projects (GAP) program, for the mosaic enhancement of the historic reflecting pool. The grant requires a 1:1 funding match, and the Art & Cultural Commission recommended \$25,000 from the Public Art Fund to assist in the project. Staff anticipates receiving the results of that grant application this December. The reflecting pool is temporarily filled to protect the public from fall hazard.

### **DISCUSSION**

The proposed Rispin Mansion Reflecting Pool Mosaic Project will transform the existing 800-square-foot pool into an artist-designed mosaic that celebrates Capitola's cultural heritage and natural environment. If the NEA grant is awarded, the project scope will include mosaic design and installation, public workshops for community input, interpretive signage, ADA-compliant accessibility features, project management, and grant administration.

The NEA application budget outlines \$50,000 in grant funding dedicated to the mosaic's design and installation. If the grant is awarded, the \$25,000 Public Art Fund allocation and NEA award will be used exclusively for art-related expenses, while staff time and resources will be applied as the City's in-kind contribution. If the grant is not awarded, the \$25,000 will remain in the Public Art Fund for future projects.

Community members have expressed concern about the pool's current condition and enthusiasm for its transformation into a mosaic artwork. Mayor Clarke suggested the Commission consider developing a Call to Artist and establishing a recommended budget for City Council review. The

Commission may also wish to explore future opportunities for public art within the park, such as enhancements to the retaining wall at the Mansion level, which is currently susceptible to graffiti. This consideration would also respond to City Council's October 24, 2024, direction to identify additional public art opportunities on the west side of Soquel creek.

**FISCAL IMPACT** The Public Art Fund has a current balance of \$125,200 with an estimated \$60,000 committed to current projects, which includes \$25,000 reserved for the NEA Grant.

**ATTACHMENT**

1. Draft Project Description for NEA FY26 GAP Grant Application
2. Park Plan
3. Images of retaining wall

**Report Prepared By:** Nikki Bryant  
Director of Community Services & Recreation

## Project Details Tab

### NEA DISCIPLINE FOR PROPOSED PROJECT\*

*Drop down, select: Visual Arts*

### PROJECT SYNOPSIS

To support the Rispin Mansion Fountain Mosaic Project, which will transform the existing 800 SF concrete fountain with a vibrant, artist-designed mosaic reflecting Capitola's history, nature, and community.

### PROJECT DESCRIPTION

#### **Project Description: Rispin Mansion Fountain Mosaic Project**

The Rispin Mansion Fountain Mosaic Project will transform the existing 800-square-foot historic concrete fountain into a stunning public artwork that celebrates Capitola's cultural heritage, natural beauty, and community identity. This project will replace the fountain's aged surface with a vibrant artist-designed mosaic, creating an interactive and visually engaging space that integrates art and nature.

Through a community-driven artist selection process, this initiative will ensure that the final design reflects the voices and visions of Capitola residents, fostering a sense of ownership and pride in public art. The Capitola Art and Cultural Commission will oversee the selection of a qualified artist or artist team to design and implement the mosaic, incorporating historical themes, regional landscapes, and environmental motifs inspired by Soquel Creek and the surrounding ecosystem.

---

### **Project Activities & Timeline**

#### **Phase 1: Artist Selection & Design Development (Months 1-5)**

- Issue a Call for Artists, encouraging submissions from local and regional artists with experience in large-scale mosaic installations.
- A selection committee, including members of the Capitola Art and Cultural Commission, city staff, and community representatives, will evaluate proposals based on artistic excellence, feasibility, and relevance to Capitola's history and landscape.
- The selected artist(s) will engage with community members through a public workshop to gather input and refine the mosaic concept.

#### **Phase 2: Community Engagement & Final Design Approval (Months 6-9)**

- The artist(s) will present preliminary designs in a public meeting, incorporating feedback from residents and local stakeholders.



- The final design will be reviewed and approved by the City of Capitola and Art and Cultural Commission.

### **Phase 3: Fabrication & Installation (Months 10-16)**

- **Surface preparation:** The fountain's existing concrete structure will be cleaned, leveled, and waterproofed.
- **Mosaic fabrication:** The artist will work in stages, creating detailed mosaic panels offsite or in a collaborative setting where the public can observe the process.
- **Installation:** The completed mosaic panels will be securely adhered to the fountain structure, followed by grouting and sealing for long-term durability.
- The city will coordinate with contractors for site logistics, ensuring minimal disruption to the park.

### **Phase 4: Public Dedication & Education (Month 17-18)**

- A community unveiling event will celebrate the project's completion, featuring discussions with the artist and interactive educational activities about public art and mosaic craftsmanship.
- The city will install interpretive signage detailing the artwork's themes, artist biography, and the significance of the Rispin Mansion and Soquel Creek to Capitola's history.

---

## **Artistic Excellence & Community Impact**

The Rispin Mansion Fountain Mosaic Project will elevate the park experience by blending historical storytelling with contemporary public art. The project's themes will draw from:

- The rich history of the Rispin Mansion as a landmark in Capitola.
- The ecological significance of Soquel Creek, incorporating imagery of native plants, wildlife, and water elements.
- The community's connection to the site, honoring Capitola's cultural evolution and its diverse residents.

This project will be publicly accessible year-round, welcoming visitors of all ages and backgrounds to experience the transformative power of art in outdoor spaces. By prioritizing local artist engagement, the project will contribute to Capitola's creative economy, providing direct compensation to artists and skilled craftspeople involved in fabrication and installation.

---

## **Budget & Project Feasibility**

This project is designed to be achievable within the available funding, ensuring high artistic quality while maintaining fiscal responsibility. The budget includes:

- \$50,000 in grant funding for artist fees, materials, fabrication, and installation.
- \$30,000 in city staff time for project oversight, logistics, and park maintenance coordination.
- \$20,000 in Local match contributions for additional material costs, community engagement activities, and interpretive signage.

The City of Capitola has extensive experience managing public art projects and will oversee all logistical and permitting requirements, ensuring timely project completion within a 9-month performance period.

---

### **Conclusion: Why This Project Matters**

The Rispin Mansion Fountain Mosaic Project will revitalize a historic public space, transforming it into a work of art that connects Capitola's past and present. By engaging the community in the creative process, this initiative will foster a deeper appreciation for public art, cultural storytelling, and environmental stewardship. The project aligns with the Arts in California Parks program's goals by creating a meaningful, inclusive, and visually captivating experience that will inspire generations of Capitola residents and visitors alike.

### **PROPOSED PROJECT START DATE/END DATE**

Start Date: 01/01/2026

End Date: 07/31/2027

### **SCHEDULE OF KEY PROJECT DATES**

#### **Phase 1: Artist Selection & Design (Jan - May 2026)**

- **January:** Issue Call for Artists
- **February:** Selection committee reviews proposals
- **March:** Artist selection and contract finalization
- **April:** Public workshop for community input
- **May:** Preliminary design presentation

#### **Phase 2: Community Engagement & Design Approval (Jun - Sep 2026)**

- **June - July:** Artists refine designs based on community feedback
- **August:** Final design approval by the City and Art Commission
- **September:** Materials procurement and preparation

### **Phase 3: Fabrication & Installation (Oct 2026 - Apr 2027)**

- **October - November:** Surface preparation (cleaning, waterproofing, leveling)
- **December - February:** Mosaic fabrication (offsite and publicly accessible workspace)
- **March - April:** Installation (affixing panels, grouting, sealing)

### **Phase 4: Public Dedication & Accessibility Enhancements (May - July 2027)**

- **May:** Community unveiling event and artist talk
- **June:** Interpretive signage installed
- **July:** Final documentation and project closeout

## **ENGAGEMENT WITH INTENDED COMMUNITY, PARTICIPANTS & AUDIENCE**

### **Engagement with Intended Community, Participants & Audience**

The Rispin Mansion Fountain Mosaic Project will engage a diverse range of community members, including local residents, artists, and visitors, fostering civic pride and cultural appreciation while ensuring accessibility and inclusion. The project will create opportunities for direct participation, allowing the public to contribute ideas, observe the mosaic's creation, and interact with the final installation.

### **Intended Communities & Audiences**

- **Local Residents:** Encouraged to participate in design workshops and public meetings to contribute ideas and cultural insights.
- **Artists & Artisans:** Opportunities for both established and emerging artists to contribute to a significant public artwork.
- **Tourists & Visitors:** The mosaic will contribute to Rispin Park as a landmark attraction, enhancing Capitola's cultural tourism appeal.
- **Historically Underserved Groups:** Outreach will include underrepresented communities, providing opportunities for active engagement in the public art process.

### **Engagement Strategies**

- **Public Workshops & Feedback Sessions:** Residents will have direct input on the artwork's design.
- **Collaborations with Local Organizations:** Partnerships with schools, community groups, and accessibility advocates.

- **Artist-Led Educational Programs:** Free demonstrations and discussions on the mosaic creation process.
- **Social Media & Public Promotion:** Updates and engagement through online platforms to reach a wider audience.

### Accessibility & Inclusion

- The mosaic and interpretive signage will be ADA-compliant, ensuring that all visitors can engage with the installation.
- Workshops and educational events will be held in physically accessible venues.
- The project will actively include people with disabilities as artists, collaborators, and audience members, ensuring non-exclusionary participation.

## PROJECT GOALS AND MONITORING

The project's goals include enhancing public art accessibility, fostering community engagement, and promoting local cultural heritage. Participants will experience hands-on artistic collaboration and cultural storytelling, strengthening their connection to public art.

### Monitoring and Evaluation

- **Attendance Tracking:** Document participation in workshops, public meetings, and unveiling events.
- **Community Feedback Surveys:** Gather input from residents and participants on engagement and impact.
- **Artist and Partner Evaluations:** Collect insights from collaborating artists and organizations.
- **Photo and Media Documentation:** Capture project progress and share learnings through public channels.
- **Post-Project Review:** Assess impact on public space use and community interaction with the completed mosaic.

Findings will be shared with local stakeholders, city officials, and the arts community, demonstrating the project's success and informing future public art initiatives.

## PROJECT PARTNERS & KEY INDIVIDUALS

1. **Partner Name:** Capitola Art and Cultural Commission
  - **Proposed or Committed:** Committed
  - **Type:** Government - Municipal
  - **Description:** The Capitola Art and Cultural Commission will oversee the artist selection process, ensuring alignment with community values and

historical significance. The commission's experience in managing public art projects ensures the installations are relevant and meaningful to Capitola's residents. Their involvement guarantees a fair and inclusive selection process, enhancing overall quality and acceptance.

2. **Partner Name:** Local Artists (Various)

- **Proposed or Committed:** Proposed
- **Type:** Individual
- **Description:** Local artists will design and fabricate the mosaic artwork for the Rispin Mansion Fountain. They will engage with the community through public workshops, incorporating local history and cultural themes into the design. By collaborating with residents, these artists will ensure the mosaic reflects Capitola's heritage and natural surroundings. Their participation will strengthen community connections to public art and create a lasting, site-specific installation.

3. **Partner Name:** Capitola Historical Museum

- **Proposed or Committed:** Committed
- **Type:** Organization - Other Non-profit
- **Description:** The Capitola Historical Museum will provide historical context and resources for the project, ensuring accuracy and depth in the historical representations within the art installations. Their expertise enhances the educational value of the project, transforming the park into a space where visitors can learn about Capitola's history through engaging and informative art.

4. **Partner Name:** City of Capitola Public Works and Community Services  
Departments

- **Proposed or Committed:** Committed
- **Type:** Government - Municipal
- **Description:** City staff from Public Works and Community Services will coordinate logistics, manage construction schedules, and oversee compliance with local regulations. Their expertise ensures that the project aligns with municipal goals for accessibility, safety, and sustainability while fostering strong community partnerships.



## **Reflecting Pool – Sheet L-1.0**

### Tile Mosaic

Description: The bottom of the reflecting pool will feature a tile mosaic depicting elements of the natural environment.

Theme: This mosaic will promote environmental stewardship by showcasing local flora and fauna, as well as aquatic motifs.





# THE PARK AT RISPIN MANSION

## Wharf Road and Clares Street

### Capitola, California

© Michael Arnone Landscape Architect - 2023

THESE DRAWINGS ARE INSTRUMENTS OF SERVICE ISSUED FOR ONE TIME SINGLE USE BY THE OWNER. THE ENTIRE CONTENTS OF THESE DRAWINGS IS COPYRIGHT © MICHAEL ARNONE LANDSCAPE ARCHITECT. LANDSCAPE ARCHITECT RETAINS ALL RIGHTS AND TITLE. NO PART MAY BE REPRODUCED IN ANY MANNER OR MEDIUM WITHOUT THE EXPRESS WRITTEN APPROVAL OF THE LANDSCAPE ARCHITECT. THE PROPER ELECTRONIC TRANSFER OF DATA SHALL BE THE USER'S RESPONSIBILITY WITHOUT LIABILITY TO THE LANDSCAPE ARCHITECT.

OWNER SHALL ASSUME RESPONSIBILITY FOR COMPLIANCE WITH ALL EASEMENTS, SETBACK REQUIREMENTS AND PROPERTY LINES. OWNER SHALL ACQUIRE ALL NECESSARY PERMITS REQUIRED TO PERFORM WORK SHOWN ON PLANS. BASE INFORMATION HAS BEEN PROVIDED BY THE OWNER. MICHAEL ARNONE LANDSCAPE ARCHITECTURE ASSUMES NO LIABILITY FOR THE ACCURACY OF SAID PROPERTY LINE BOUNDARIES, FENCE LINES OR PROPERTY CORNERS.

## REVISIONS

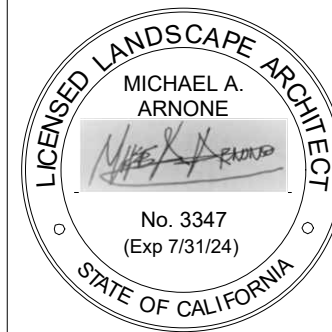

## SITE PLAN & PHASING PLAN

JOB NO. 201503

SCALE 1/16" = 1' - 0"

DRAWN MA

CHECK JC/MA

DATE 2.22.2023

SHEET

L- 1.0

SHEET 2 OF 20

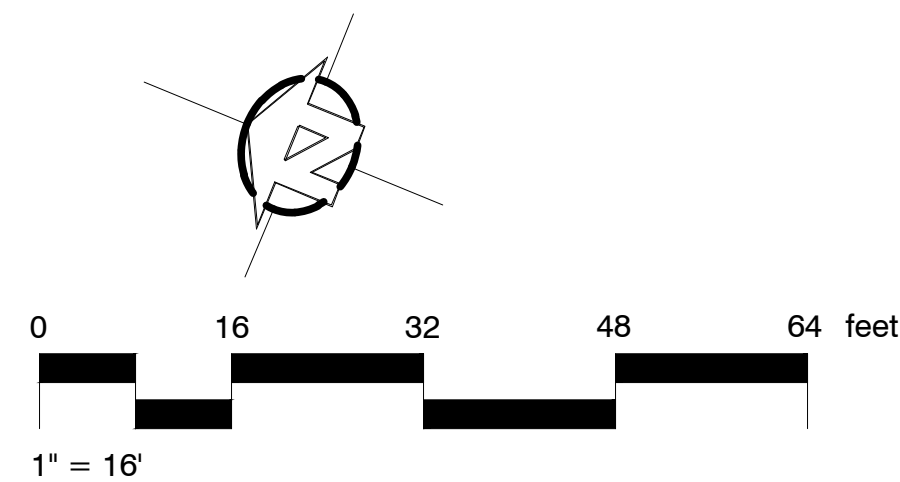
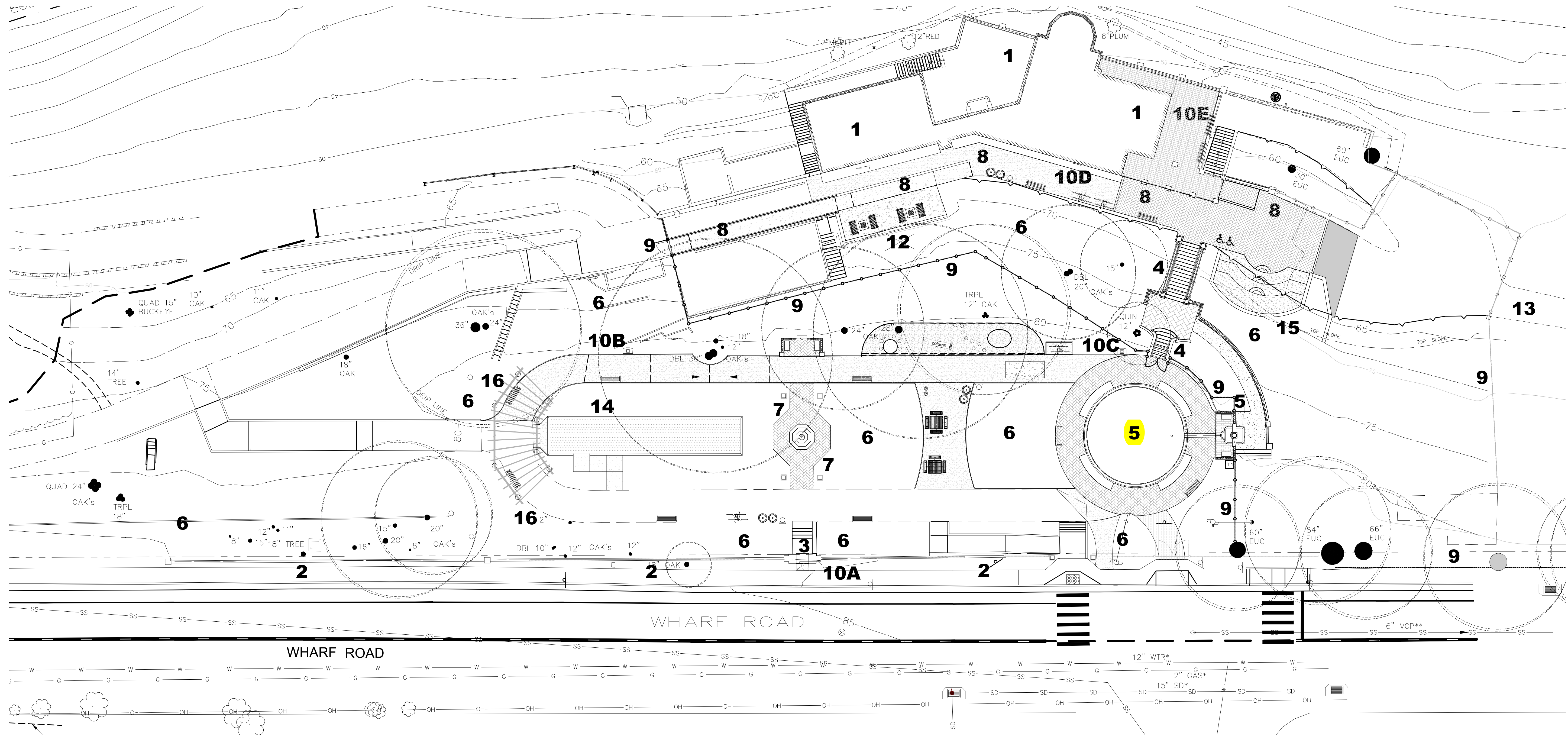

### EXISTING FEATURES AND PROPOSED AMENITIES

(N) denotes new element

(H) denotes existing element found on site

1. RISPIN MANSION BUILDING (H)
2. WHARF ROAD WALL(H)
3. WHARF ROAD ENTRY STEPS(H)
4. GRAND STAIRCASE AND BALUSTRADE (H)
5. FOUNTAIN AND REFLECTION POOL (H)
6. PLANTS AND LANDSCAPE (N)
7. SUNDIAL (H) AND SCULPTURE GARDEN (N)
8. UNIVERSAL ACCESS PATH OF TRAVEL (N)
9. FENCING AND GATES (N)
10. SIGNAGE (N)
11. IMPROVE STRIPING AND CROSSWALKS AT CLARES/WHARF ROAD INTERSECTION (N)
12. MURAL ON CONCRETE WALL OF SAINT CLARES BUILDING(N)
13. INFORMAL SERVICE DRIVE/PEDESTRIAN PATH FROM MANSION TERRACE TO SOUTH ENTRANCE AT WHARF ROAD (H)
14. BOCCIE BALL COURT (N)
15. AMPHITHEATER (N)
16. ARBOR (H)

### Summary of Historic Elements found on Rispin Site and Proposed Renovations

#### Discussion of Intent.

The project goals for Rispin Park are to create a community park that provides passive recreation and focuses on the cultural, historical, and open space resources that are unique to the Rispin Mansion Site. The intent of the restoration is to provide examples of the architectural style of the mansion and to create a public awareness of the significance of the Mansion building and grounds as part of the history of the City of Capitola. It should be stated that the park is not intended to be an exact replication of the mansion grounds during the time it was the residence of Henry Rispin. A summary of the existing historic elements and the proposed modifications are explained below and noted on the Site Plan.

#### Wharf Road Wall, Entry Arch and Entry Staircase:

- Portions of the Existing wall along Wharf Road will remain unchanged, while some sections of the existing wall height will be reduced to 30' with a 30" decorative metal fence on top. One portion of the wall at the southern end of the road frontage will be removed to allow a new universally accessible entrance to the park. The section to be removed will incorporate a new column to match the existing last column at the southern terminus of the wall. Bollards and metal fencing will be added to the new park entrance.
- Steps and side walls of the staircase at the entry will be rebuilt and repaired. The Arch and side walls will be painted to match the Mansion.
- Existing wood gate to be removed and stored for display with other artifacts

#### Arbor:

- New columns will match historic columns found on site in height and architectural detail.
- Spacing of columns and location will be changed to accommodate new universally accessible path, and mature oaks on site.
- New vine species compatible with native oaks will be selected.

#### Sundial:

- Existing sundial base will remain in its present location. Pedestal will be rebuilt according to archive photographs. New, contemporary sundial/compass will be chosen, no archive photos are available that show the sundial piece.

#### Overlook:

- Existing overlook columns and base wall to remain. All caps and balustrades to be rebuilt according to archive photographs and existing artifacts on-site.
- New benches in same location as historical shown in archive photographs, architectural details not discernable in photos. New benches will be simple without ornamentation.

#### Reflecting Pool:

- Existing location and size of pool will remain unchanged. Depth of pool will be reduced to maximum of 6 inches. Repairs will be made to coping, pool sides and bottom. Plumbing and bottom of pool will be retrofitted to incorporate rainwater harvesting system.
- Brick path around pool will be installed, consistent with archive photos.
- New sculpture in center of pool will replace water feature(s) shown in archive photos. New sculpture will be distinctly different in style than those of the Rispin period.
- A tile mosaic is proposed for the bottom of the fountain. Mosaic will be commissioned by Capitola Arts Commission.

#### Wall Fountain and Lower Sitting Area behind Wall Fountain:

- Existing fountain will be repaired to working condition. Missing parts will be reconstructed using archive photographs and site artifacts.
- Urn will be selected to match historic using archive photographs.
- New fountain spout will be selected, historical fountain spout style not discernable in photos. New fountain spout will be simple without ornamentation.
- Lower seating area behind fountain and balustrade wall from grand staircase will be repaired according to archive photographs and existing artifacts on-site. Pathway from brick landing to seating area will be rebuilt.

#### Grand Staircase:

- All walls, columns, column caps, brick landings, to be repaired according to archive photographs and existing artifacts on-site. Steps to be rebuilt.
- A new metal handrail as per code will be added on each side, mounted in ground outside of cheek wall.

#### Miscellaneous Garden Features

- 12" high concrete wall along old walkway at northwest corner of park to remain.
- Rock fossil walls by staircase to remain.
- Stone wall at north end of park by new ramp to remain.
- Existing 18" wide red concrete steps north of arbor to remain; add handrail as per code
- Existing 4' wide concrete steps by Game Table area to remain; add chain barricade and sign to close off















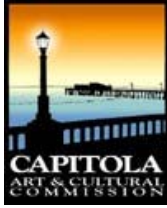

Item #: 8.c

# ART & CULTURAL COMMISSION AGENDA REPORT

## MEETING OF October 14, 2025

FROM: Staff  
DATE: September 29, 2025  
SUBJECT: Reschedule November Meeting

---

**Recommended Action** Choose a new date for the November meeting due to Holiday.

### **BACKGROUND**

The Art & Cultural Commission meets on the second Tuesday of each month. In November the regular scheduled meeting, November 11, 2025, is Veterans Day which is a city holiday.

### **DISCUSSION**

The Commission can choose a new date for the November meeting to occur or choose not to hold a November meeting. The next regular meeting would be December 9, 2025

**FISCAL IMPACT** None

### **ATTACHMENT**

**Report Prepared By:** Nikki Bryant  
Director of Community Services & Recreation