

CAPITOLA

ART & CULTURAL COMMISSION

MEETING AGENDA

Tuesday, June 14, 2016

6:30 p.m.

City Council Chambers

Commission Members

Michael Termini ~ Chair

Nathan Cross~ Vice Chair

Mary Beth Cahalen

Laurie Hill

Kim Hogan

David Kraemer

Joyce Murphy

Linda Smith

Jenny Shelton

- 1. Call to Order-Roll Call**
- 2. Approval of Agenda-**
- 3. Oral Communications-**
- 4. Approval of Minutes- May 10, 2016**
- 5. General Business –**
 - a. Wharf Road Mural - Presentation**
 - b. Summer Events Update (Verbal)**
 - c. Plein Air (Verbal)**
 - d. Entry Signs to Capitola**
 - e. Rispin Fountain**
 - f. Public Art (Verbal)**
- 6. Commissioner Reports-**
- 7. Staff Report-**
- 8. Communications-**
- 9. Future Agenda Items-**
- 10. Adjournment**

Staff Representatives

Kelly Barreto &
Larry Laurent

Notice: The Art and Cultural Commission meets on the second Tuesday at 6:30 PM in the City Council Chambers located at 420 Capitola Avenue, Capitola.

Agenda and Agenda Packet Materials: The Art and Cultural Commission Agenda is available on the City's website: www.cityofcapitola.org/ on Friday prior to the Tuesday meeting. If you need additional information please contact the City Hall Department at (831) 475-7300.

Americans with Disabilities Act: Disability-related aids or services are available to enable persons with a disability to participate in this meeting consistent with the Federal Americans with Disabilities Act of 1990. Assisted listening devices are available for individuals with hearing impairments at the meeting in the City Council Chambers. Should you require special accommodations to participate in the meeting due to a disability, please contact the City Clerk's office at least 24-hours in advance of the meeting at 831-475-7300. In an effort to accommodate individuals with environmental sensitivities, attendees are requested to refrain from wearing perfumes and other scented products.

Appeals: Any person who believes that a final action of this advisory body has been taken in error may appeal that decision to the City Council. Appeals must be in writing and delivered to the City Clerk's Office within ten (10) working days from the time of the boards' decision. The notice of appeal shall set forth appellant's name, phone number, address to which notices may be sent to the appellant, and the grounds upon which the appeal is made.

CAPITOLA
ART & CULTURAL COMMISSION
DRAFT MEETING MINUTES

Tuesday, May 10, 2016 6:30 p.m.
City Council Chambers

1. **Call to Order-Roll Call:** Present: Termini, Cross, Murphy, Hill, Shelton, Hogan
Absent: Kraemer, Smith, Cahalen
2. **Approval of Agenda-** M/S Shelton/Murphy Approved Unanimously
3. **Oral Communications-** Commissioner Shelton reported the Creative Workforce grant for public art was not approved. Chair Termini requested that commission request reason.
4. **Approval of Minutes-** M/S Hill/Murphy. Approved unanimously
5. **General Business-**
 - a. **Summer Events (Verbal)** Staff Laurent gave status report on the schedule and the postcard. Signup sheet for the Summer Events was passed around
 - b. **Plein Air (Verbal)** Commissioner Shelton reported that that eight artists met to brainstorm ideas for 2016 Plein Air event. Initial meeting of 4 of the 6 committee member met on May 9th. Commissioner Shelton is chair and Commissioner Hill is co-chair. Committee is working on changes and creating an operations manual for the event. Plan is to allow for more painting days during the week and to have a media day on Friday. Committee is planning on using New Brighton Middle School for the Sunday Event. Commissioner Shelton believes that the total budget should be around \$9000, but they will improve fundraising by looking for additional sponsorship opportunities. Investigating a capital campaign to purchase 20 panels for the event. Commissioner Hill commented that the Artists they spoke with expect a commission on the sale of the work. Commissioner Shelton stated that have a percentage of sales go toward a charity might also improve sales. Based on input from the artists, they will be looking to move the event to May. Commissioner Shelton reported that they will be looking to implement a jurying process this year. The committee feels that better artists will bring better collectors which will help with sales.
 - c. **Public Art (Verbal)** Staff Laurent handed out plans regarding the handrail on Capitola Avenue. Reported that he met Public Work Director Jesberg and the hand rail project could move forward prior to the rest of the sidewalk structure. Staff will look at the process for the Kiosk and CAFÉ for posting of the call to artists. Commissioner Cross stated that he was under the impression that the City Hall sculpture was ready to move forward, and was told by Staff Laurent that that was not the case and that the entire City Hall project would need to be approved. Chair Termini stated that the project would have to go to Council.
6. **Commissioner Reports** – Chair Termini brought the clothing inventories and discussed what needed to be ordered. Stickers and Patches will also be available at the events. Consensus was that stickers should be free and the patches will be sold for five dollars.
7. **Staff Report-** None
8. **Oral Communications-**
9. **Future Agenda Items** – Wharf Road Overcrossing,

10. Adjournment at 7:30 pm

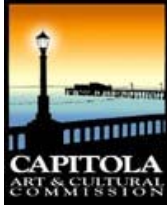

ART & CULTURAL COMMISSION AGENDA REPORT

MEETING OF JUNE 14, 2016

FROM: STAFF
DATE: June 9, 2016
SUBJECT: Capitola Welcome Signs

Recommended Action: Consider Capitola Entry Signs as Public Art Project

BACKGROUND

At the May 10, 2016 Art and Cultural Commission, Commissioner Shelton requested that the Entry to Capitola Signs be brought up as a potential Public Art Project. At the June 1, 2016 City Council budget Hearing, the Council requested that the Art and Cultural Commission consider replacing the Entry to Capitola Signs.

DISCUSSION

Currently there are five painted wood signs that signal to vehicles that they are entering Capitola by the Sea. The signs are currently installed at the following locations;

- 41st Avenue Northbound at the Railroad Tracks
- 41st Avenue Southbound at Gross Road
- Capitola Road Eastbound at 30th Avenue
- Cliff Road Eastbound at Portola and Opal Cliff
- Park Avenue Southbound near Highway One off-ramp.

The signs are several years old and the condition varies. There are other potential location for signs that could be considered, including Bay Avenue. The Commission need to consider if they would like to move forward with this as a public art project. If the Commission does want to move forward, staff would bring more details on the current requirements for such signs and budget estimates at a future meeting. The Commission could then decide to move forward with a call to artists.

FISCAL IMPACT

Unknown at this time

ATTACHMENT

Photographs of Current Signs

Report Prepared By: Larry Laurent
Assistant to the City Manager

Photographs of Current Entry Signs



41st Avenue Northbound at Railroad Tracks



41st Avenue Southbound at Gross Road



Capitola Road Eastbound at 30th Avenue

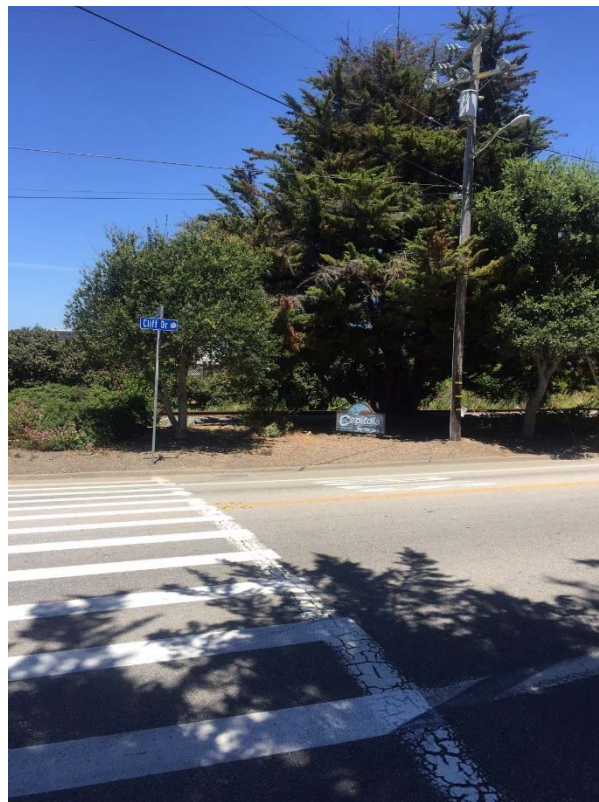

Cliff Road Eastbound at Portola and Opal Cliff



Park Avenue Southbound near Highway One off-ramp.

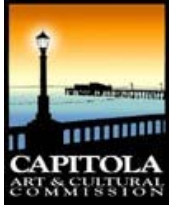

Item #: 5.e

ART & CULTURAL COMMISSION AGENDA REPORT

MEETING OF JUNE 14, 2016

FROM: STAFF
DATE: June 9, 2016
SUBJECT: Rispin Fountain

Recommended Action: Consider Fountain at Rispin Mansion as Public Art Project

BACKGROUND

At the June 1, 2016 City Council budget Hearing, the City Council tentatively approved budgeting for the gardens at Rispin Mansion, but due to the cost, a working fountain was not included. The Council requested that the Art and Cultural Commission consider replacing the Entry to Capitola Signs.

DISCUSSION

The City of Capitola is currently in the second phase of a three phase project to open the gardens at the Rispin Mansion to the public. As part of the third phase of the project, the Capitola City Council has requested that the Art and Cultural Commission consider Public Art for interior of the fountain. The cost estimates for install a working fountain were in excess of \$300,000 and funds were not available at this time for this part of the project. If the Commission does want to move forward, staff would bring more details on the project requirements and timing at a future meeting. The Commission could then decide to move forward with a call to artists.

FISCAL IMPACT

Unknown at this time

ATTACHMENT

Photographs of Rispin Fountain
Rispin Fountain Plan

Report Prepared By: Larry Laurent
Assistant to the City Manager

Photographs of Rispin Fountain



EXISTING FEATURES AND PROJECT GOALS

(N) denotes new element
(H) denotes existing element found on site

1. RISPIN MANSION BUILDING (H)
2. WHARF ROAD ENTRY AND WALL(H)
3. WHARF ROAD ENTRY STEPS(H)
4. GRAND STAIRCASE AND BALUSTRADE (H)
5. FOUNTAIN AND REFLECTION POOL (H)
6. PLANTS AND LANDSCAPE (N)
7. SUNDIAL (H) AND SCULPTURE GARDEN (N)
8. UNIVERSAL ACCESS PATH OF TRAVEL (N)
9. FENCING AND GATES (N)
10. SIGNAGE (N)
11. IMPROVE STRIPING AND CROSSWALKS AT CLARES/WHARF ROAD INTERSECTION (N)
12. MURAL ON CONCRETE WALL OF SAINT CLARES BUILDING(N)
13. INFORMAL SERVICE DRIVE/PEDESTRIAN PATH FROM MANSION TERRACE TO SOUTH ENTRANCE AT WHARF ROAD (H)
14. BOCCIE BALL COURT (N)
15. AMPHITHEATER (N)

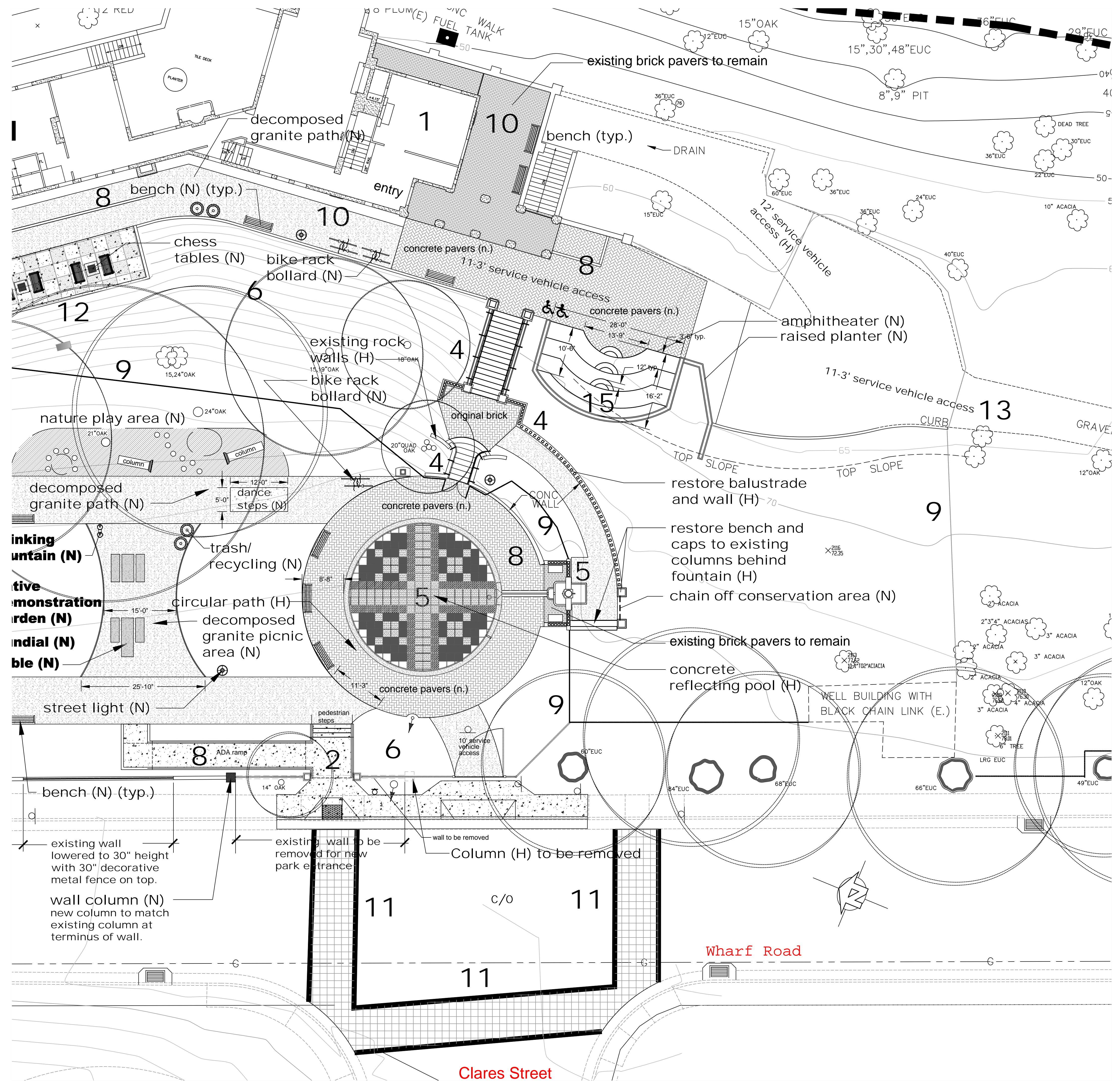

80% SUBMITTAL - NOT FOR CONSTRUCTION

Michael Arnone + Associates
LANDSCAPE ARCHITECTURE
3370 Samuel Place Santa Cruz, CA 95062
831.462.4988 mike@arnonelandscapes.com www.arnonelandscapes.com

RISPIN MANSION PARK
WHARF ROAD AND CLARES STREET
CAPITOLA, CALIFORNIA



DATE	PURPOSE	BY
4.11.15	first issue review	MAA
4.24.15	second review submission	MAA
5.28.15	City Council review	MAA
12.30.15	80% bid set	MAA

scale:
1" = 10' - 0"

sheet title:
hardscape plan
south end

sheet number:
L - 1.2