



AGENDA
LIBRARY AD HOC COMMITTEE
3:30 p.m., Tuesday, Oct 21, 2014
Council Chambers
420 Capitola Avenue, Capitola, CA 95010

Members:

Council Member Michael Termini, Council Member Dennis Norton, Barbara Gorson, Dave Kraemer, Gayle Ortiz, Lisa Steingrube, Susan Westman, Beau Kayser, Rebecca Hobson, Sandra Sandoval

- 1. Review Sept 16 Minutes**
- 2. Finalize pro/con table of locations**
- 3. Consider recommendation to City Council regarding location for future Capitola Branch Library**
- 4. Process moving forward**



AGENDA
LIBRARY AD HOC COMMITTEE
3:30 p.m., Tuesday, Sept 16, 2014
Council Chambers
420 Capitola Avenue, Capitola, CA 95010

Members Present: Council Member Michael Termini, Council Member Dennis Norton, Barbara Gorson, Dave Kraemer, Gayle Ortiz, Lisa Steingrube, Beau Kayser, Rebecca Hobson, Sandra Sandoval. Also Present: Jamie Goldstein, Teresa Landers, Pam Anderson, Rich Grunow

1. Review July 29 Minutes

The group unanimously accepted the July 29 meeting minutes

2. Review previous design work / Library Needs Assessment

The group reviewed and discussed previous site design alternatives prepared by Pam Anderson. Overall, the group preferred design option #1 (shown below), which would place a new library on the southern end of the property. Possible design modifications were discussed to allow a more rectangular shaped facility; however, concerns over saving existing oak trees and retaining a highly-functional playground may present challenges. Teresa noted that a more rectangular facility is preferred from an operational perspective, but added that the layout of design option #1 would be operationally acceptable.

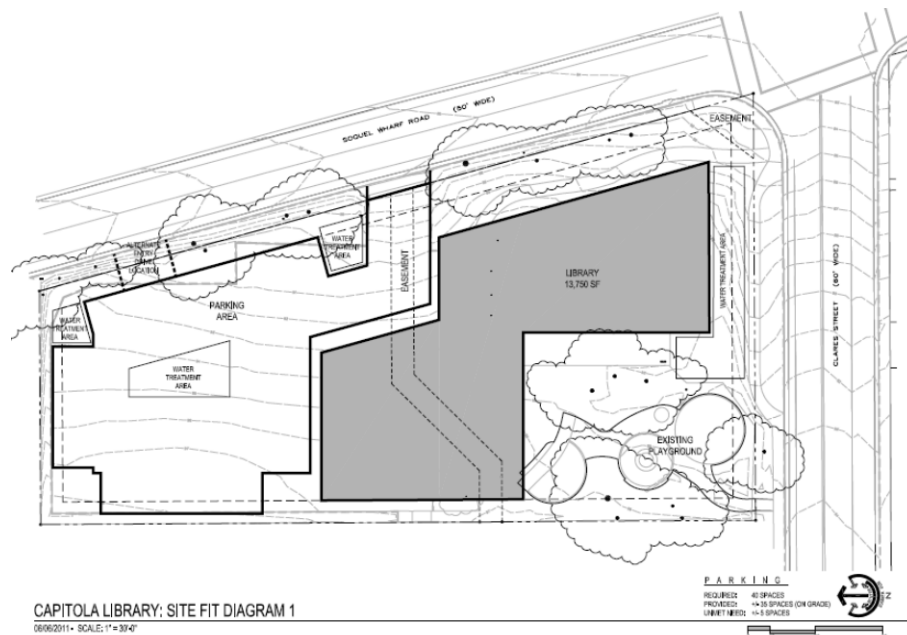

3. Process/timeline check in

Jamie provided a brief overview of the process timeline. The group discussed the need to develop sketches of a potential facility prior to the 2015 ballot measure to help voters visualize the proposal.

4. Next meeting

The next library subcommittee meeting is scheduled for October 21, 2014.

Current Site	
<p>Pros</p> <ul style="list-style-type: none"> • Close multi residential housing • Easy access to Central Soquel • Adjacent to Rispin • Near 41st retail • On north-south travel route • Near “center of town” 	<p>Cons</p> <ul style="list-style-type: none"> • Site may require additional land acquisition for 12,000-13,000 SF library • Temporary impacts to library services during construction • Parking for potential future Rispin project may be impacted, depending on land acquisitions.
Monterey/Pac Cove Site	
<p>Pros</p> <ul style="list-style-type: none"> • Near NB Middle School • No land acquisition necessary • Also near “center of town” • On east-west travel route/freeway access • Near future Pac Cove park • Co-location of public facilities • Leverages other City goals <ul style="list-style-type: none"> ○ First responders out of flood zone ○ Component of parking structure/open space plan for Pac Cove ○ Economic development 	<p>Cons</p> <ul style="list-style-type: none"> • Summer parking challenges • Complicated large scale project • Hillside construction • Former RDA funding limited to interior finishes and furnishing