

CITY OF CAPITOLA

2015 STREET REHABILITATION PROJECT

NCE
 501 Canal Blvd., Suite 1
 Richmond, Ca. 94804
 (510) 215-3620 * Fax (510) 215-2898

GENERAL NOTES

- ALL DRAWINGS AND SPECIFICATIONS ARE CONSIDERED PART OF THE CONTRACT DOCUMENTS. THE CONTRACTOR SHALL BE RESPONSIBLE FOR REVIEW AND COORDINATION OF ALL DRAWINGS AND SPECIFICATIONS PRIOR TO START OF CONSTRUCTION. ANY DISCREPANCIES THAT OCCUR SHALL BE BROUGHT TO THE ATTENTION OF THE ENGINEER PRIOR TO THE START OF CONSTRUCTION SO THAT A CLARIFICATION MAY BE ISSUED. WORK NOT CONFORMING TO THE CONTRACT DOCUMENTS SHALL BE CORRECTED BY THE CONTRACTOR AT NO EXPENSE TO THE CITY.
- DRAWING BASE MAP IS BASED ON SANTA CRUZ COUNTY PARCEL DATA. PARCEL LINES ARE APPROXIMATE AND ARE FOR INFORMATIONAL PURPOSES ONLY.
- SPECIFIC NOTES AND DETAILS TAKE PRECEDENCE OVER GENERAL NOTES AND TYPICAL DETAILS.
- IT SHALL BE THE CONTRACTOR'S RESPONSIBILITY TO FIELD VERIFY LOCATIONS OF EXISTING FACILITIES AND TO IMMEDIATELY NOTIFY THE ENGINEER IN WRITING OF ANY FIELD CONFLICTS.
- ALL MATERIALS AND WORKMANSHIP SHALL FULLY CONFORM WITH THE SPECIFICATIONS, STANDARDS, AND ORDINANCES OF THE CITY OF CAPITOLA, THE LATEST SANTA CRUZ COUNTY STANDARD PLANS, AND THE CALTRANS STANDARD SPECIFICATIONS (LATEST REVISION). STANDARD PLANS ARE AVAILABLE AT THE OFFICE OF THE ENGINEER.
- CONTRACTOR SHALL MEET WITH THE CITY PRIOR TO START OF CONSTRUCTION. 48 HOURS NOTICE TO THE ENGINEER IS REQUIRED ON ALL INSPECTIONS.
- CONTRACTOR IS RESPONSIBLE TO MAKE ALL ARRANGEMENTS FOR SITE INSPECTIONS AND ENSURE THAT ALL CURRENT STANDARDS FOR THE CITY, SANTA CRUZ COUNTY, AND CALTRANS ARE FOLLOWED PRIOR TO BEGINNING ANY PHASE OF CONSTRUCTION WORK.
- CONTRACTOR SHALL VERIFY DIMENSIONS PRIOR TO START OF CONSTRUCTION. THE ENGINEER SHALL BE NOTIFIED OF ANY DISCREPANCIES OR INCONSISTENCIES.
- CONSTRUCTION SHALL BE LIMITED TO BETWEEN THE HOURS OF 8:00 A.M. AND 4:30 P.M., MONDAY THROUGH FRIDAY AND INSPECTION REQUESTS SHALL BE LIMITED TO NORMAL CITY BUSINESS HOURS: 8:30 A.M. TO 5:00 P.M., MONDAY THROUGH FRIDAY. ARRANGEMENTS FOR ANY OVERTIME INSPECTION SERVICES AND PAYMENTS OF FEES FOR SAME SHOULD BE MADE 48 HOURS IN ADVANCE AND ARE SUBJECT TO INSPECTION AVAILABILITY AND APPROVAL BY THE ENGINEER.
- THE CITY IS RESPONSIBLE FOR ARRANGEMENTS TO PAY FOR ALL MATERIAL TESTING REQUIRED FOR QUALITY ASSURANCE/ACCEPTANCE OF THIS PROJECT. IT IS THE CONTRACTOR'S RESPONSIBILITY TO SEE TO IT THAT ALL MATERIAL TESTING REQUIRED BY THE ENGINEER AND QUALITY CONTROL TESTING, PER THE SPECIAL PROVISIONS, IS PERFORMED. ENGINEER WILL ONLY PERFORM QUALITY ASSURANCE TESTING. IT IS THE CONTRACTOR'S RESPONSIBILITY TO NOTIFY THE ENGINEER 24 HOURS IN ADVANCE OF QUALITY ASSURANCE TESTING TO ALLOW THE ENGINEER TO SCHEDULE MATERIAL TESTING LAB SAMPLING OR TESTING.
- DUST CONTROL DURING ALL PHASES OF CONSTRUCTION IS THE RESPONSIBILITY OF THE CONTRACTOR. IT IS ALSO THE CONTRACTOR'S RESPONSIBILITY TO MAINTAIN GOOD HOUSEKEEPING WITHIN THE CONSTRUCTION AREA AND STAGING AREA.
- WATER FOR DUST CONTROL AND USE FOR COMPACTION MAY BE PURCHASED FROM THE APPROPRIATE AGENCY PRIOR TO THE START OF ANY WORK, AND IT IS THE RESPONSIBILITY OF THE CONTRACTOR TO PAY FOR ANY FEES OR DEPOSITS.
- PRIOR TO CONSTRUCTION, THE CONTRACTOR SHALL SUBMIT FOR APPROVAL THE PROPOSED ROUTE(S) FOR ALL CONSTRUCTION TRAFFIC RELATED TO THE PROJECT. UPON APPROVAL, THE CONTRACTOR SHALL STRICTLY ADHERE TO THAT ROUTE(S) ONLY, UNLESS WRITTEN PERMISSION IS OBTAINED TO CHANGE THE ROUTE(S). IN ADDITION TO THE CONTRACTOR'S PROPOSED ROUTE(S), A DETOUR PLAN SHALL BE SUBMITTED FOR APPROVAL BY THE ENGINEER.
- CONTRACTOR SHOULD NOTE THE PRESENCE OF OVERHEAD UTILITIES IN THE WORK AREA. AS PART OF THEIR PRE-BID INSPECTION, CONTRACTOR SHALL NOTE THE TYPE AND LOCATION OF OVERHEAD UTILITIES IN THE PROPOSED WORK AREA. CONTRACTOR'S PRICE SHALL INCLUDE PROVISIONS FOR WORKING IN AREAS WHERE UTILITIES EXIST AT THE TIME OF BIDDING, AND NO ADDITIONAL COMPENSATION IS ALLOWED.
- THE CONTRACTOR SHALL MAINTAIN ACCESS TO RESIDENCES AND BUSINESSES AFFECTED BY THE PROJECT THROUGHOUT THE LIFE OF THE CONTRACT AS SPECIFIED IN THE SPECIAL PROVISIONS.
- LOCATIONS OF EXISTING MONUMENTS, MANHOLES, WATER VALVES, ETC. ARE APPROXIMATED BASED ON FIELD OBSERVATIONS. IT SHALL BE THE CONTRACTOR'S RESPONSIBILITY TO CONFIRM THE EXISTENCE AND LOCATION OF ALL UNDERGROUND UTILITIES.
- CONTRACTOR SHALL NOTIFY UNDERGROUND SERVICES ALERT (U.S.A.) 800-227-2600 (OR DIAL 811), TWO (2) WORKING DAYS PRIOR TO START OF ANY EXCAVATION OR DEMOLITION OF IMPROVEMENTS.
- ANY DAMAGE TO THE EXISTING FACILITIES INCLUDING TREES, LANDSCAPING, FENCES, WALLS, SIDEWALK, MAILBOXES, UTILITIES, AND OTHER PAVEMENT SURFACES SHALL BE REPAIRED AT CONTRACTOR'S EXPENSE. CONTRACTOR SHALL RESTORE ANY AND ALL PAVEMENT AND OTHER FACILITIES OUTSIDE LIMITS OF WORK AFFECTED BY THE CONSTRUCTION OPERATIONS AT NO ADDITIONAL COST. IT IS THE CONTRACTOR'S RESPONSIBILITY TO VIDEOTAPE OR DOCUMENT EXISTING CONDITIONS PRIOR TO START OF WORK TO SUBSTANTIATE ANY PREVIOUS DAMAGE, ETC.; COPIES OF WHICH SHALL BE PROVIDED TO THE ENGINEER.
- ALL SURVEY MONUMENTS SHALL ONLY BE RESET BY A REGISTERED CIVIL ENGINEER OR LICENSED LAND SURVEYOR AT THE DIRECTION OF THE ENGINEER.
- ALL STRIPING AND MARKINGS SHALL BE THERMOPLASTIC. ALL BLUE REFLECTIVE FIRE HYDRANT MARKERS SHALL BE SET 6" OFF THE STREET CENTERLINE OR CENTERLINE STRIPING.
- TRAFFIC CONTROL DURING CONSTRUCTION SHALL BE THE CONTRACTOR'S RESPONSIBILITY AND IN ACCORDANCE WITH THE CONTRACT DOCUMENTS. THE CONTRACTOR SHALL PROVIDE ALL LIGHTS, SIGNS, BARRICADES, FLAGMEN, AND OTHER DEVICES TO PROVIDE FOR SAFE PASSAGE OF PUBLIC VEHICULAR AND PEDESTRIAN TRAFFIC IN ACCORDANCE WITH CA MUTCD.
- TYPICAL DETAILS REFERRED TO ON THESE DRAWINGS ARE FROM THE LATEST VERSIONS OF THE CALIFORNIA DEPARTMENT OF TRANSPORTATION (CALTRANS) STANDARD PLANS, AND SANTA CRUZ COUNTY STANDARD PLANS.
- CONTRACTOR SHALL POSSESS A VALID CLASS 'A' LICENSE AT THE TIME OF AWARD OF THE CONTRACT.

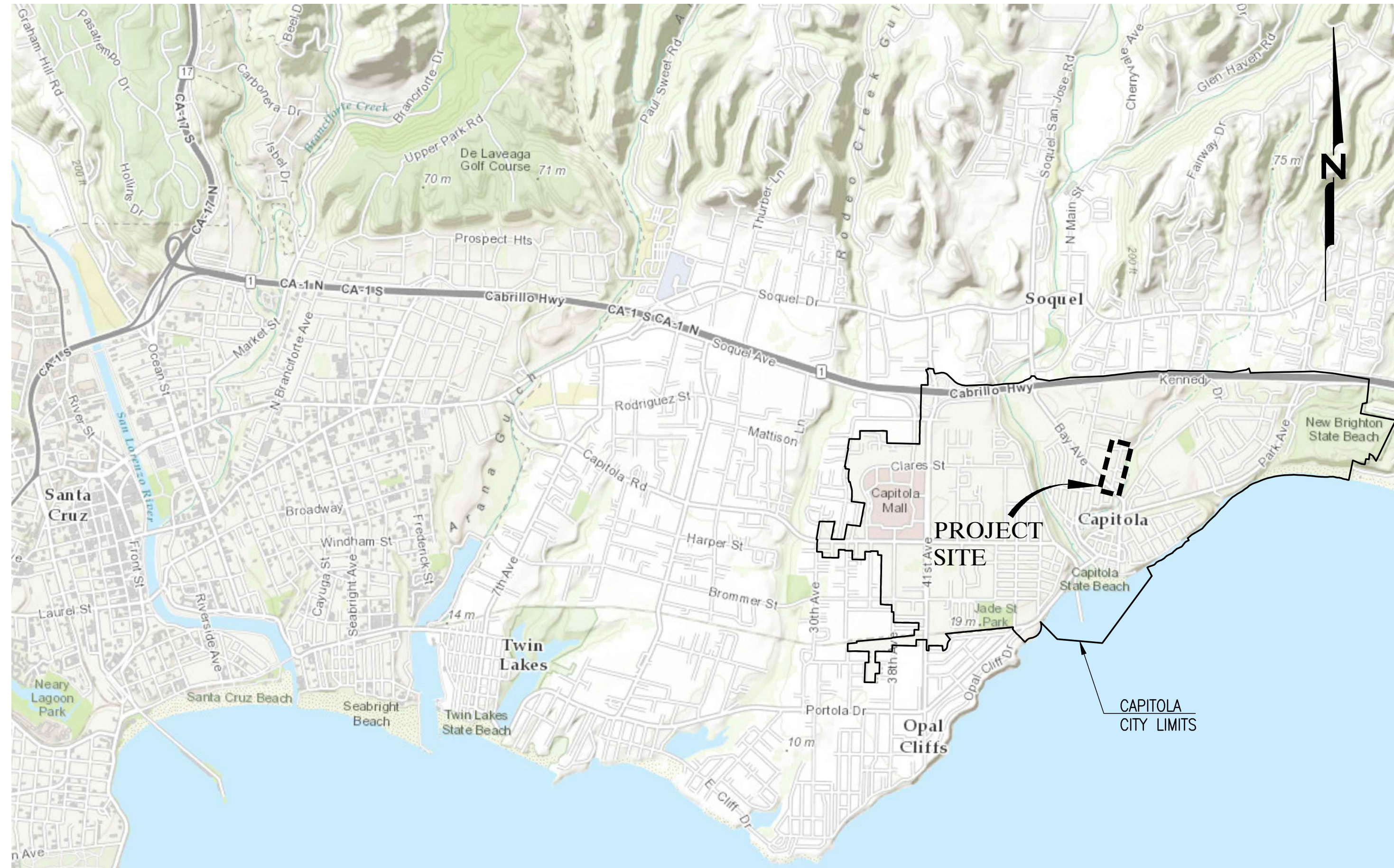

LOCATION MAP
 NOT TO SCALE

SHEET INDEX		
SHEET NO.	DRAWING NO.	SHEET TITLE
1	G1	TITLE SHEET
2	C1	VICINITY MAP AND CROSS-GUTTER DETAIL
3	D1	CONSTRUCTION DETAILS AND SECTIONS

ABBREVIATIONS

AB	AGGREGATE BASE	N	NORTH, NORTHING
AC	ASPHALT CONCRETE	N.T.S.	NOT TO SCALE
CL	CENTERLINE	NO.	NUMBER
EA	EACH	PCC	PORTLAND CEMENT CONCRETE
EG	EXISTING GRADE	PSI	POUNDS PER SQUARE INCH
EP	EDGE OF PAVEMENT	PVC	POLYVINYL CHLORIDE
FG	FINISHED GRADE	SCH	SCHEDULE
FT	FEET	SDMH	STORM DRAIN MANHOLE
HMA	HOT MIX ASPHALT	SF	SQUARE FEET
LF	LINEAR FOOT	SSCO	SANITARY SEWER CLEAN OUT
M.D.D.	MINIMUM DRY DENSITY	SSMH	SANITARY SEWER MANHOLE
MIN	MINIMUM	TYP	TYPICAL
MON	MONUMENT	WV	WATER VALVE

PREPARED UNDER THE DIRECTION OF: *Franz Haidinger* 06/23/2015
 FRANZ HAIDINGER, P.E.
 ASSOCIATE ENGINEER, NCE DATE

REVIEWED BY: *J. Ryan Shafer* 06/23/2015
 RYAN SHAFER, P.E.
 ASSOCIATE ENGINEER, NCE DATE

APPROVED BY: *Steve Jesberg* 02/26/2016
 STEVE JESBERG, P.E.
 PUBLIC WORKS DIRECTOR, CITY OF CAPITOLA DATE

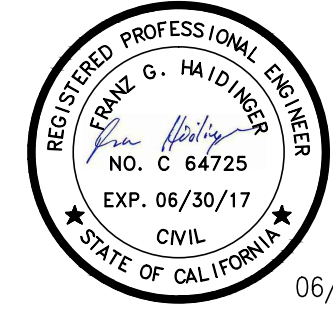

2015 STREET REHABILITATION PROJECT

OWNER



420 CAPITOLA AVENUE
 CAPITOLA, CA 95010

NO.	DATE	DESCRIPTION
1	06/23/2015	ISSUED FOR CONSTRUCTION

PROJECT NO:	303.05.55
DESIGNED BY:	JB
DRAWN BY:	AP
CHECKED BY:	FGH DATE: 06/12/2015
DATE:	06/23/2015

This drawing is the property of NCE, including all patented and patentable features, and/or confidential information and its use is conditioned upon the user's agreement not to reproduce the drawing, in whole or part, nor the material described thereon, nor the use of the drawing for any purpose other than specifically permitted in writing by NCE.

SHEET TITLE

TITLE SHEET

DRAWING

G1

SHEET 1 OF 3





501 Canal Blvd., Suite I
Richmond, Ca. 94804
(510) 215-3620 * Fax (510) 215-2898



06/23/2015

2015 STREET
REHABILITATION
PROJECT

OWNER



420 CAPITOLA AVENUE
CAPITOLA, CA 95010

NO.	DATE	DESCRIPTION
△	06/23/2015	ISSUED FOR CONSTRUCTION

PROJECT NO:	303.05.55
DESIGNED BY:	JB
DRAWN BY:	AP
CHECKED BY:	FGH DATE: 06/12/2015
DATE:	06/23/2015

This drawing is the property of NCE, including all patented and patentable features, and/or confidential information and its use is conditioned upon the user's agreement not to reproduce the drawing, in whole or part, nor the material described thereon, nor the use of the drawing for any purpose other than specifically permitted in writing by NCE.

SHEET TITLE

VICINITY MAP
AND
CROSS GUTTER DETAIL

DRAWING

C1

SHEET 2 OF 3

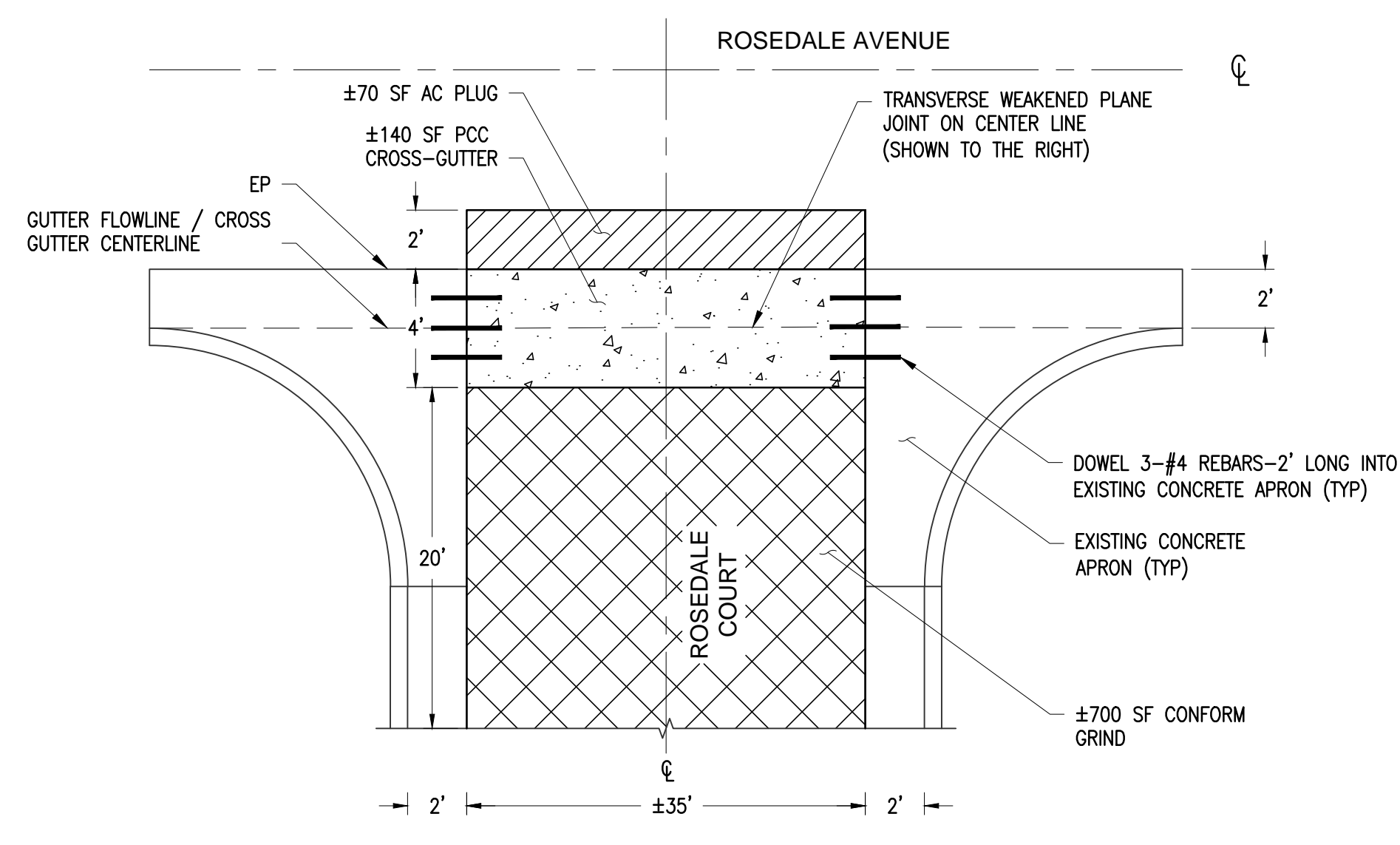
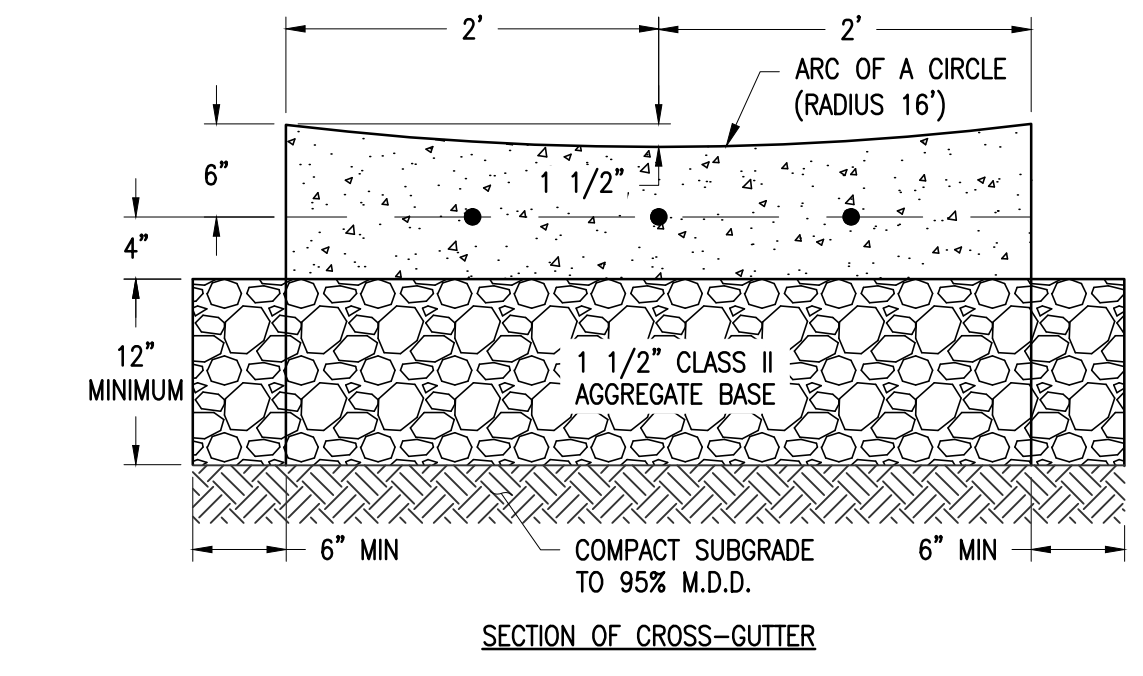
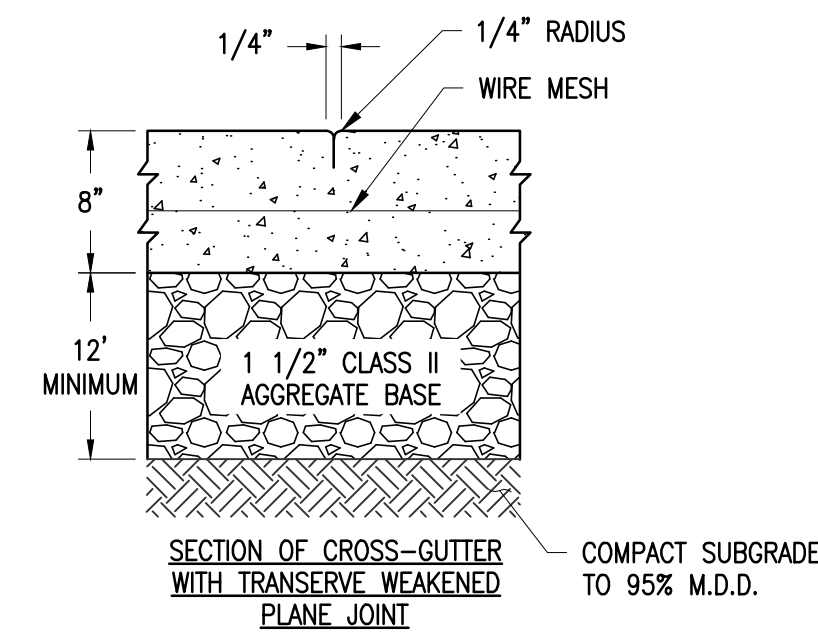
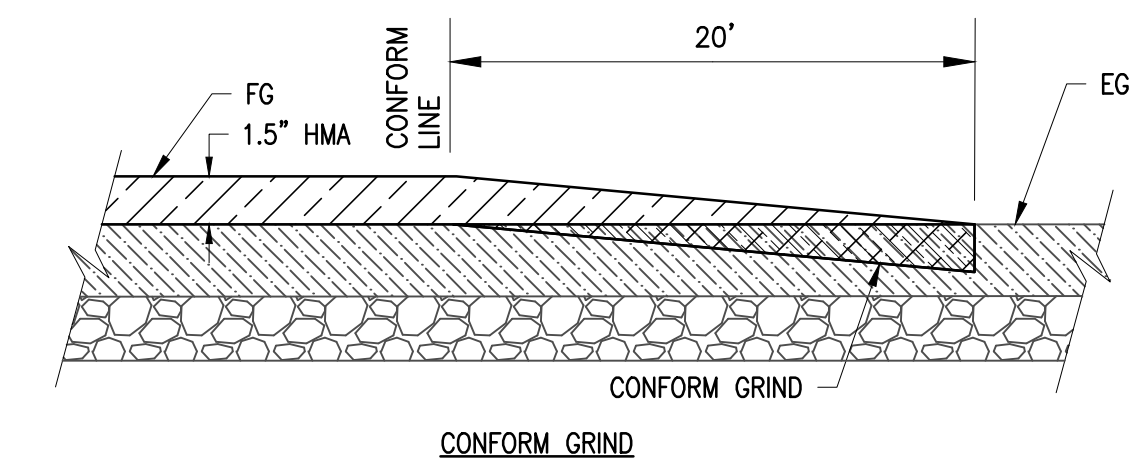

1
C1 STANDARD 4' WIDE CROSS-GUTTER
(ROSEDALE COURT)
N.T.S.

- SOURCE: MODIFIED FROM CITY OF CAPITOLA STANDARD PLANS "4' STANDARD CROSS GUTTER", DRAWN 04/2012
- NOTES:
1. WIRE MESH SHALL BE 6" X 6" SQUARE NO. 10 X NO. 10 ELECTRICALLY WELDED WIRE AND SHALL MEET THE REQUIREMENTS OF A.S.T.M DESIGNATION 1185-53-T.
 2. CONCRETE SHALL MEET 3,000 PSI IN 28 DAY REQUIREMENTS (MINIMUM).
 3. TACK COAT SHALL BE APPLIED TO ALL EXISTING AC AND PCC SURFACE PRIOR TO PLACEMENT OF NEW HMA.

NO.	LENGTH (FT)	WIDTH (FT)	AREA (SF)
1	31	7	217
2	16	5	80
3	9	5	45
4	28	6	168
5	18	7	126
6	56	8	448
7	26	11	286
8	19	8	152
9	60	8	480
10	24	5	108
11	50	8	400
12	25	7	163
13	22	5	110
14	8	10	80
TOTAL			2,863

NO.	LENGTH (FT)	WIDTH (FT)	AREA (SF)
1	11	5	55
TOTAL			55

STREET NAME	BLUE RAISED MARKERS (EA)	TP STRIPE (LF) DETAIL 22	TP STRIPE (LF) LIMIT LINE	TP LEGEND (22 SF) "STOP"	TP BASIC CROSSWALK (LF)
ALMA LANE	1				
ROSEDALE AVENUE	4	100	18	2	89
ROSEDALE COURT	1				

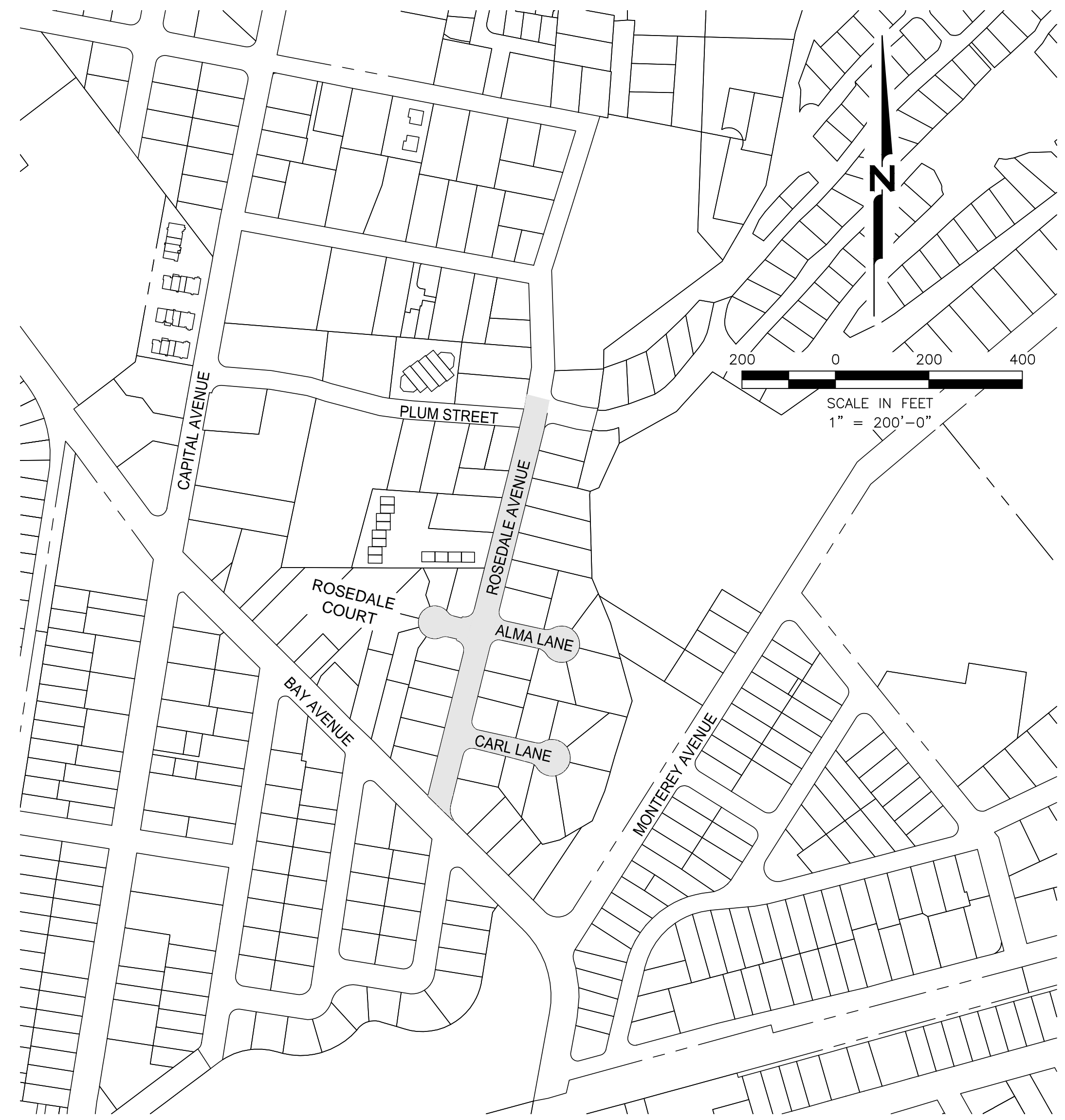

STREET TREATMENTS	STREET NAME	BEGIN	END	LENGTH (FT)	AREA (SF)	TREATMENT	DETAIL NO.
	ALMA LANE	ROSEDALE AVENUE	END	182	6,584	REMOVE 4" AC/AB AND 4" HMA OVERLAY	3/D1
	CARL LANE	ROSEDALE AVENUE	END	221	7,694	REMOVE 4" AC/AB AND 4" HMA OVERLAY	3/D1
	ROSEDALE AVENUE	BAY AVENUE	36' NORTH OF PLUM STREET (PAVEMENT CHANGE)	905	33,118	2" MILL AND 2" HMA OVERLAY	2/D1
	ROSEDALE COURT	ROSEDALE AVENUE	END	116	5,349	1.5" HMA OVERLAY	1/D1, 5/D1

STREET NAME	SURVEY MON	SURVEY NAIL	WV BOX	BLOWOFF VALVE	SSMH	SSCO	SDMH	GAS BOX
ALMA LANE					1	1		
CARL LANE					2			
ROSEDALE AVENUE	1	1	4		4	1	5	1
ROSEDALE COURT	1		2	1	1			

STREET	BEGIN	END	CORE NO.	DIRECTION	DEPTH TO FABRIC (IN)	AC OVERLAY THICKNESS TOP-DOWN (IN)	TOTAL AC THICKNESS (IN)	AB THICKNESS (IN)	MOISTURE CONTENT (%)	PLASTICITY INDEX	R-VALUE
ALMA LANE	ROSEDALE AVENUE	EAST END	ALM-2	EB	NONE	1.625, 1.0	2.625	6.5	24.5	38.0	2.0
CARL LANE	ROSEDALE AVENUE	EAST END	CAR-1	EB	NONE	1.25, 1.5	2.75	5.875	21.7	32.0	3.0
ROSEDALE AVENUE	BAY AVENUE	36 FT NORTH OF PLUM STREET (PAVEMENT CHANGE)	ROS-1	NB	NONE	3.125, 1.5, 1.5	6.125	AB PRESENT	-	-	-
			ROS-2	SB	NONE	2.875, 1.5	4.375	AB PRESENT	-	-	-
ROSEDALE COURT	WEST END	ROSEDALE AVENUE	ROC-2	WB	NONE	1.875	1.875	AB PRESENT	-	-	-



File: P:\Active Projects\Capitola City - 303.05.55 - Capitola 2015-16 Street Rehabilitation\CD\Sheets\C1 Vicinity Map.dwg | Layout: C1 | Printed: Jun 23, 2015 @ 4:50pm | D:\p2015 -\cd\105 -\form

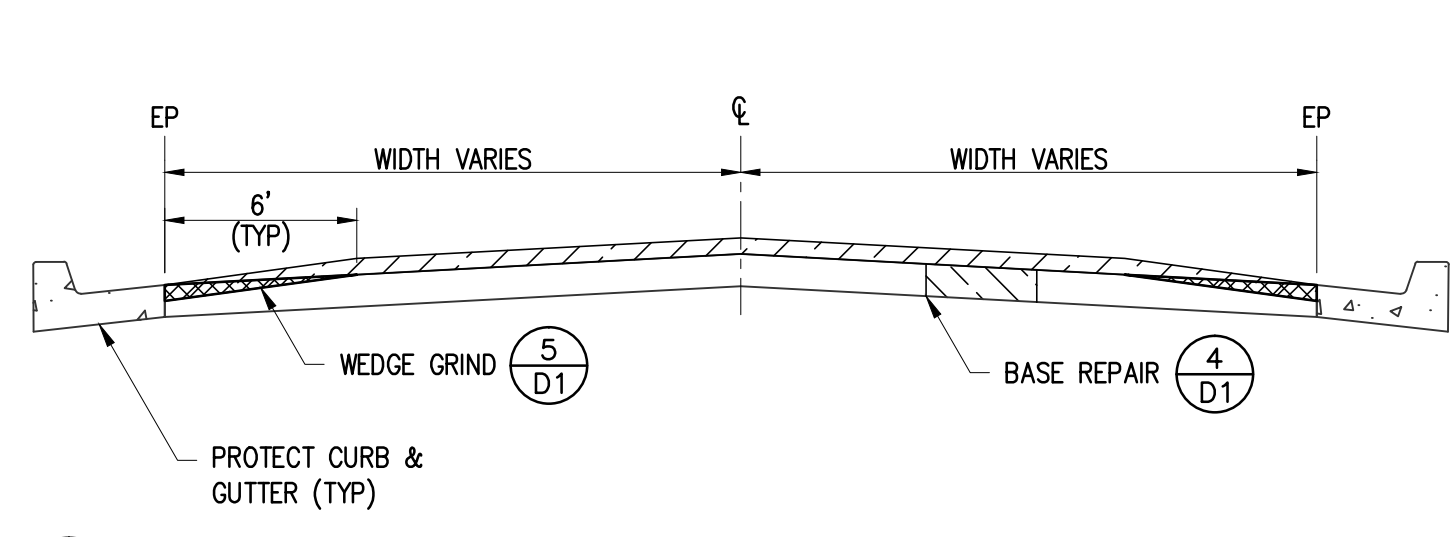

1
D1
1.5" HMA OVERLAY
N.T.S.

- NOTES:
- CORE MEASUREMENTS FOR TYPICAL PAVEMENT SECTION CAN BE FOUND ON DRAWING C1.
 - CRACK SEAL APPLICATION BEFORE OVERLAY PER SPECIAL PROVISIONS "SP-25: CRACK SEALING".

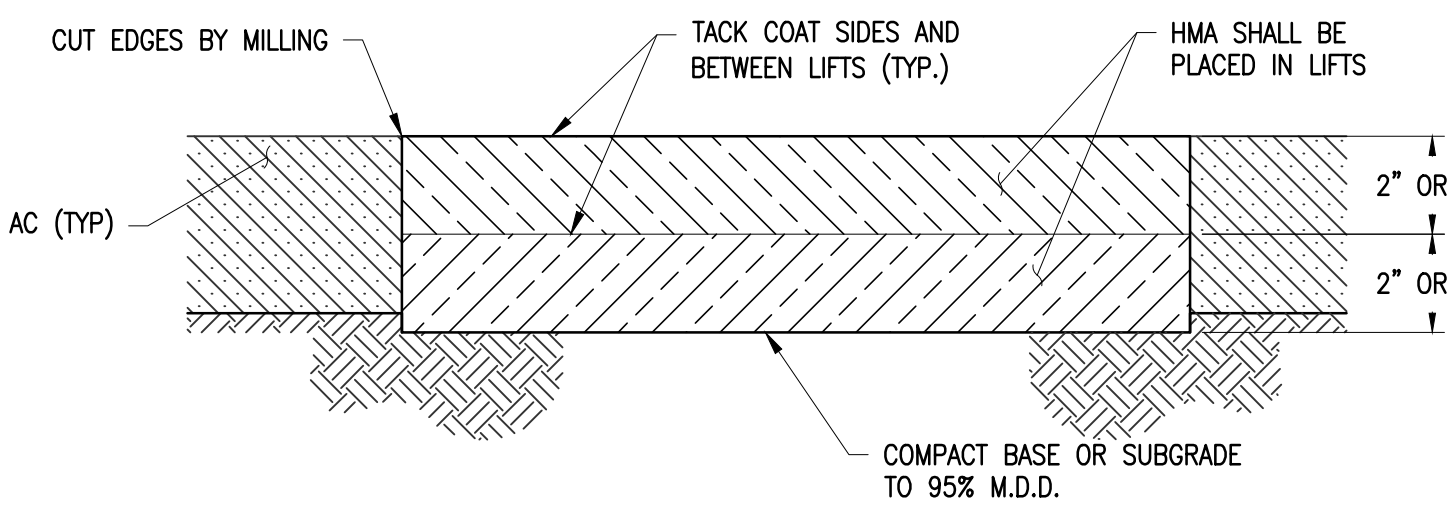

4
D1
ASPHALT CONCRETE BASE REPAIR (4" OR 6")
N.T.S.

- NOTES:
- APPROXIMATE BASE REPAIR SIZES ARE PROVIDED ON DRAWING C1. EXACT LOCATIONS AND SIZES OF BASE REPAIRS SHALL BE DETERMINED IN THE FIELD BY THE CONTRACTOR AND CITY INSPECTOR. THE AGREED UPON DIMENSIONS SHALL BE RECORDED AND SUBMITTED TO THE CITY AND CONSTITUTE THE FINAL PAY QUANTITY.
 - TACK COAT SHALL BE APPLIED TO ALL PAVEMENT SURFACES PRIOR TO PLACEMENT OF EACH LIFT OF NEW ASPHALT CONCRETE.
 - OVER-EXCAVATE IF UNSUITABLE SUBGRADE MATERIAL IS ENCOUNTERED. SEE SPECIAL PROVISIONS "SP-22: PAVEMENT BASE REPAIR".
 - LIFTS SHALL BE PLACED IN EQUAL DEPTH LAYERS.

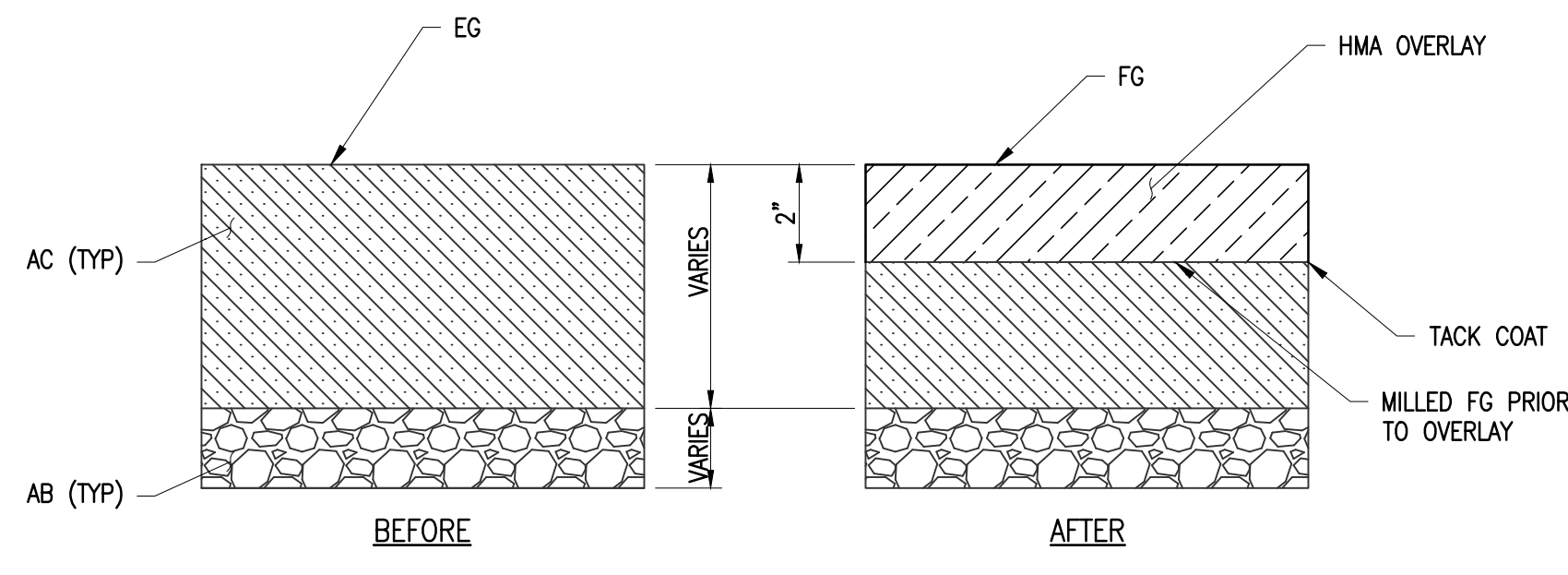

2
D1
2" MILL AND 2" HMA OVERLAY
N.T.S.

- NOTES:
- CORE MEASUREMENTS FOR TYPICAL PAVEMENT SECTION CAN BE FOUND ON DRAWING C1.
 - CRACK SEAL APPLICATION BEFORE OVERLAY PER SPECIAL PROVISIONS "SP-25: CRACK SEALING".

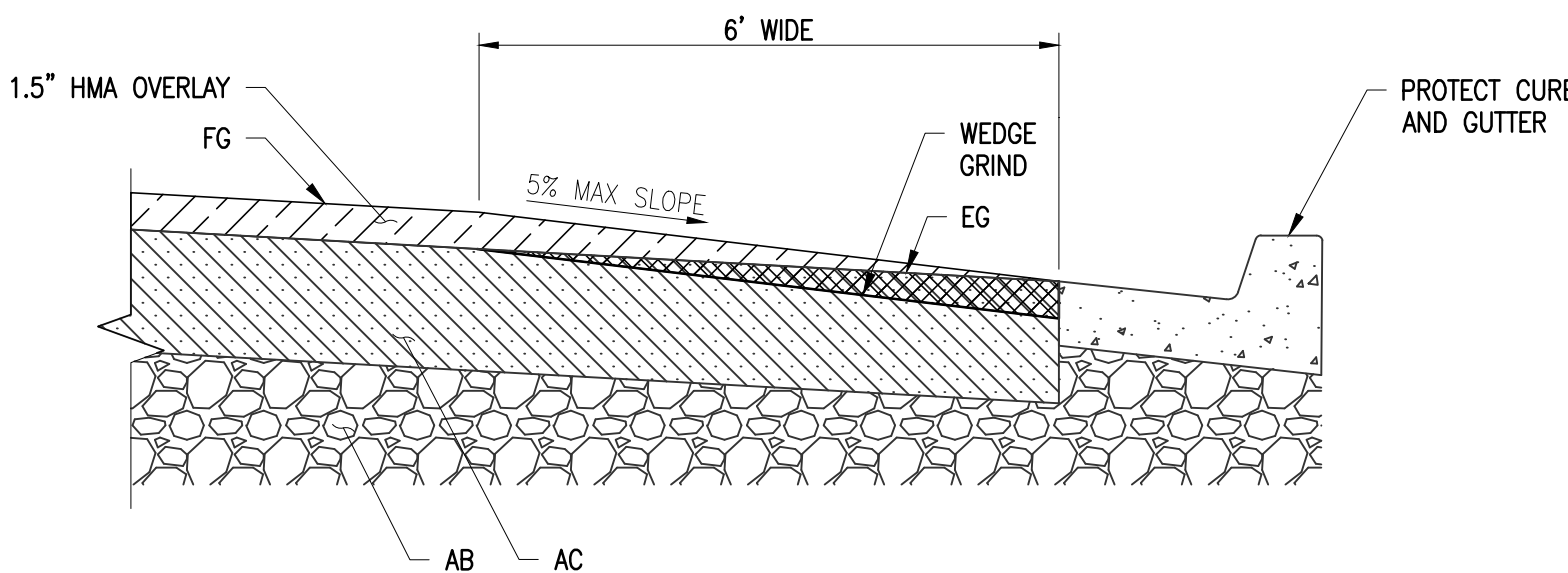

5
D1
WEDGE GRIND ALONG CURB AND GUTTER (1.5" HMA OVERLAY)
N.T.S.

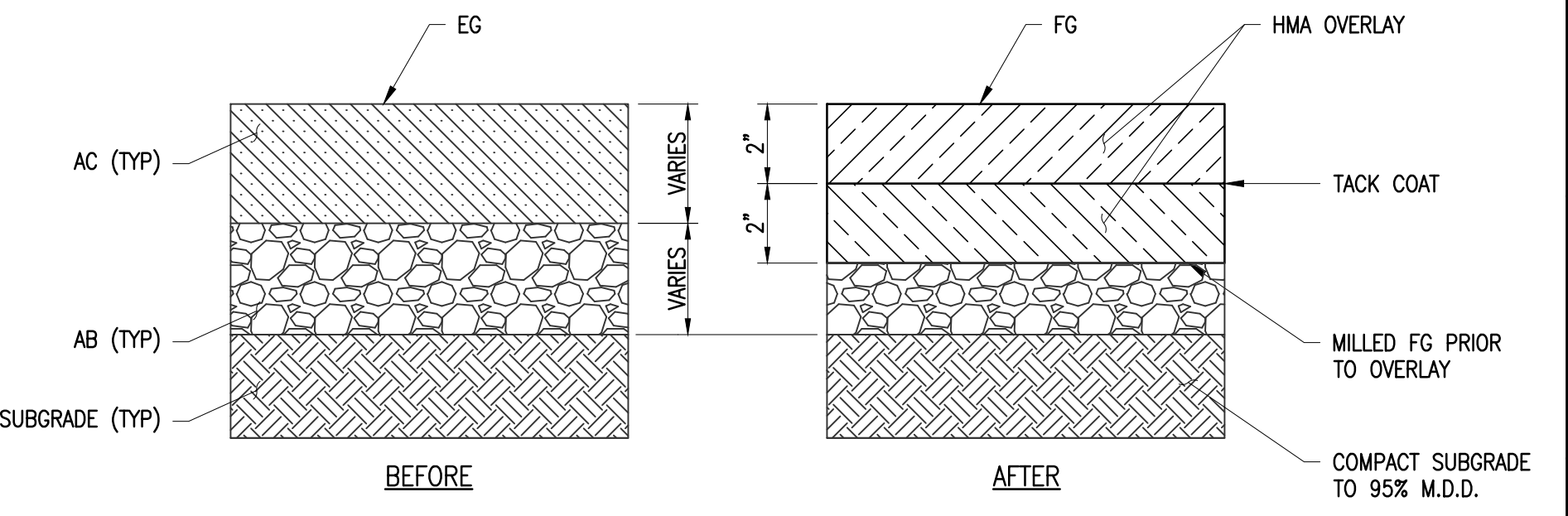

3
D1
SURFACE RECONSTRUCT: REMOVE 4" AC/AB REPLACE WITH 4" HMA OVERLAY
N.T.S.

- NOTES:
- CORE MEASUREMENTS FOR TYPICAL PAVEMENT SECTION CAN BE FOUND ON DRAWING C1.
 - OVER-EXCAVATE IF UNSUITABLE SUBGRADE MATERIAL IS ENCOUNTERED. SEE SPECIAL PROVISIONS "SP-15: SUBGRADE PREPARATION" FOR DETAILS.

File: P:\Active Projects\Capitola City - 303\303.05.55 - Capitola 2015-16 Street Rehabilitation\CD\Sheets\01 Details\01.dwg | Layout: D1 | Printed: Jun 23, 2015 @ 4:20pm | D:\p\2015 (JMS - Tech)

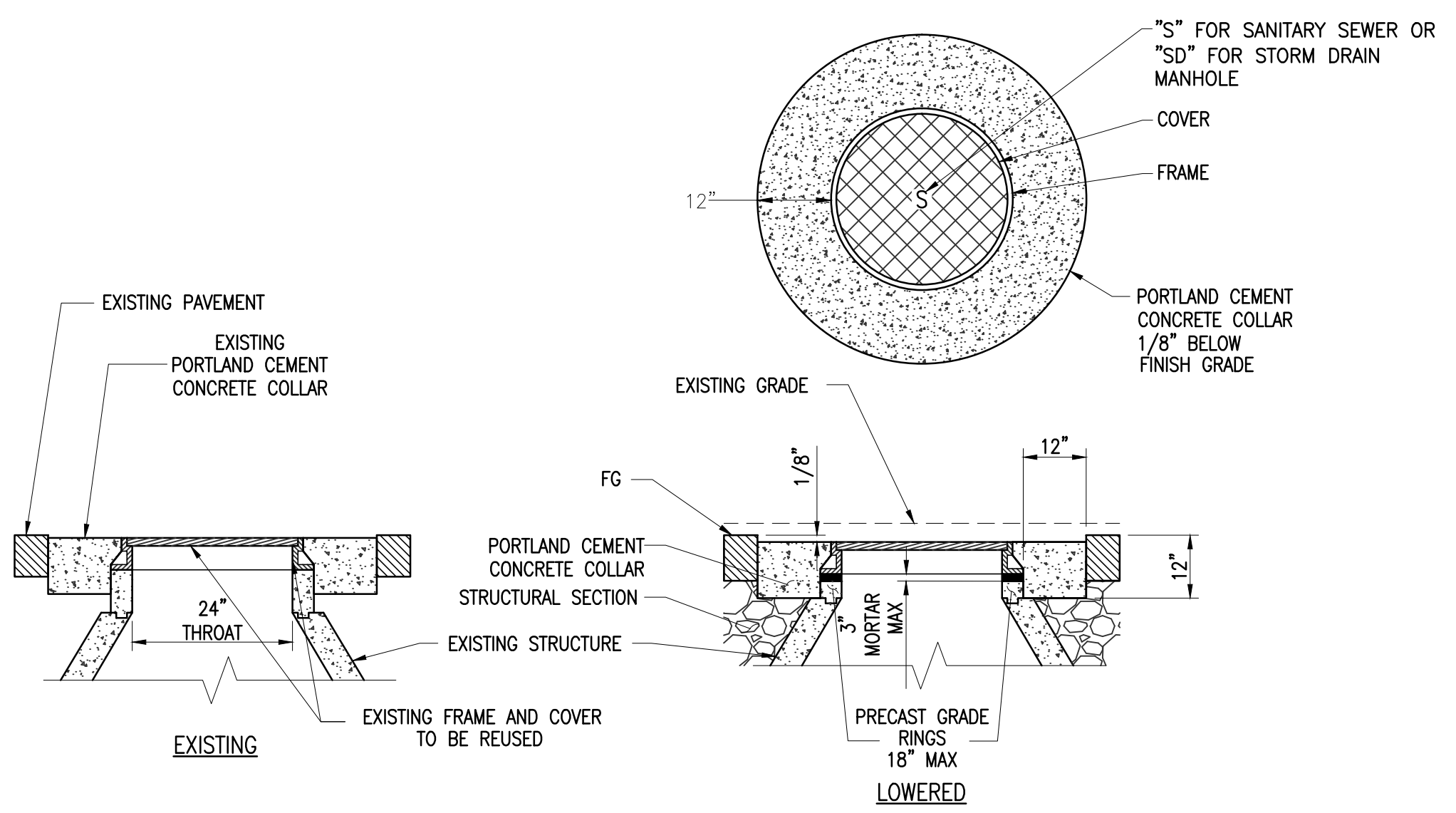

6
D1
MANHOLE ADJUSTMENT DETAIL
N.T.S.

- NOTES:
- BREAK DOWN MANHOLE COVER AND FRAME TO ALLOW INSTALLATION OF TEMPORARY TRAFFIC RATED COVER AT TEMPORARY GRADE.
 - INSTALL NEW MANHOLE COVER OR FRAME IF EXISTING IS DAMAGED. NEW MANHOLE LID SHALL CONFORM TO SPECIAL PROVISIONS.
 - PCC COLLAR SHALL BE PLACED AROUND EACH MANHOLE REGARDLESS OF WHETHER A COLLAR WAS PRESENT PRIOR TO THE WORK.

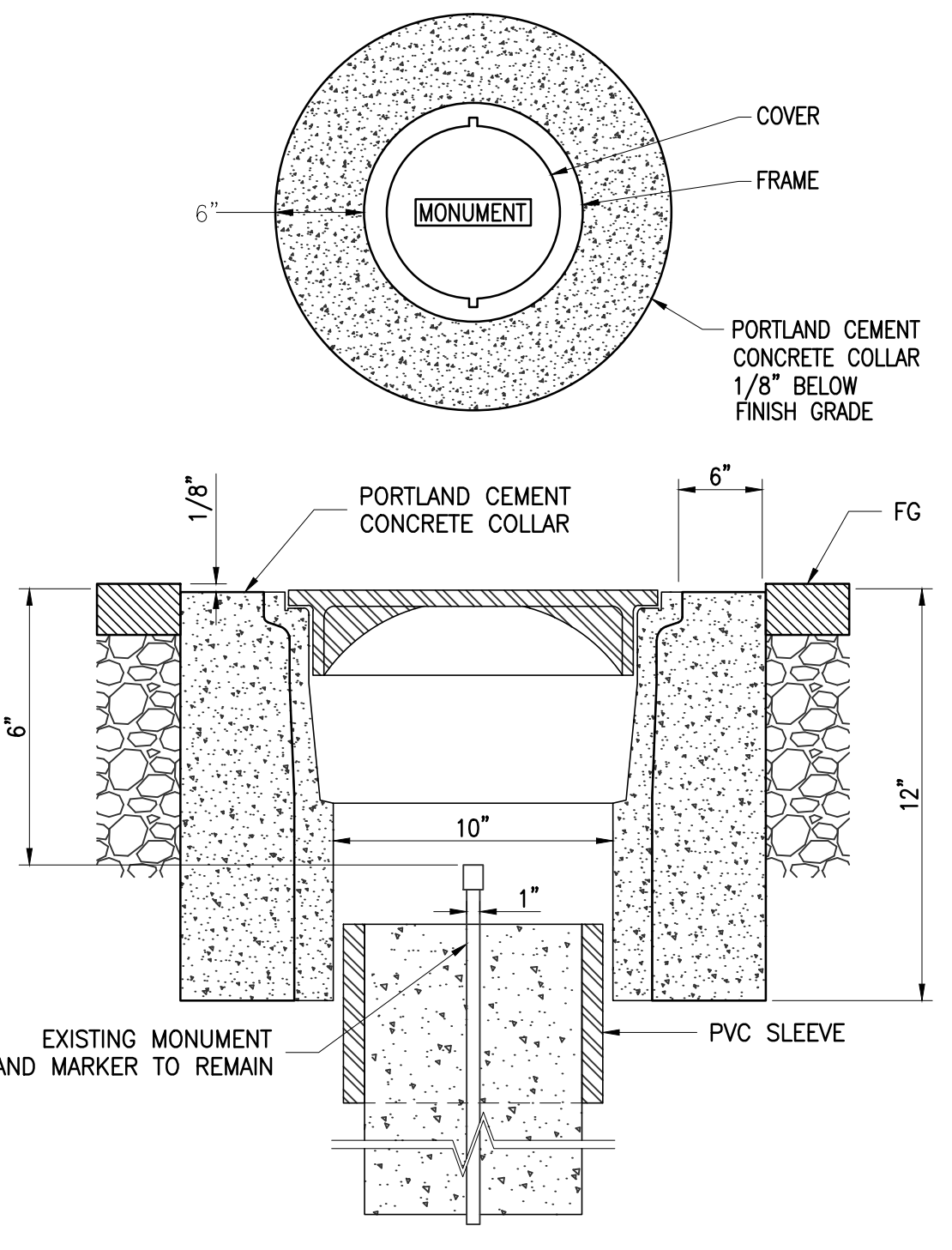

7
D1
SURVEY MONUMENT ADJUSTMENT DETAIL
N.T.S.

- NOTES:
- MONUMENT BOX AND COVER TO CONFORM TO SPECIAL PROVISIONS.
 - SURVEY MONUMENT BOX LID SHALL BE OILED PRIOR TO PAVING OR CLEANING TO ENSURE THAT MARKINGS ARE LEGIBLE.
 - INSTALL VALVE BOX LID TO BE FLUSH WITH CONCRETE COLLAR AND 1/8" BELOW FINISH GRADE.
 - USE OF GRADE RINGS PROHIBITED.

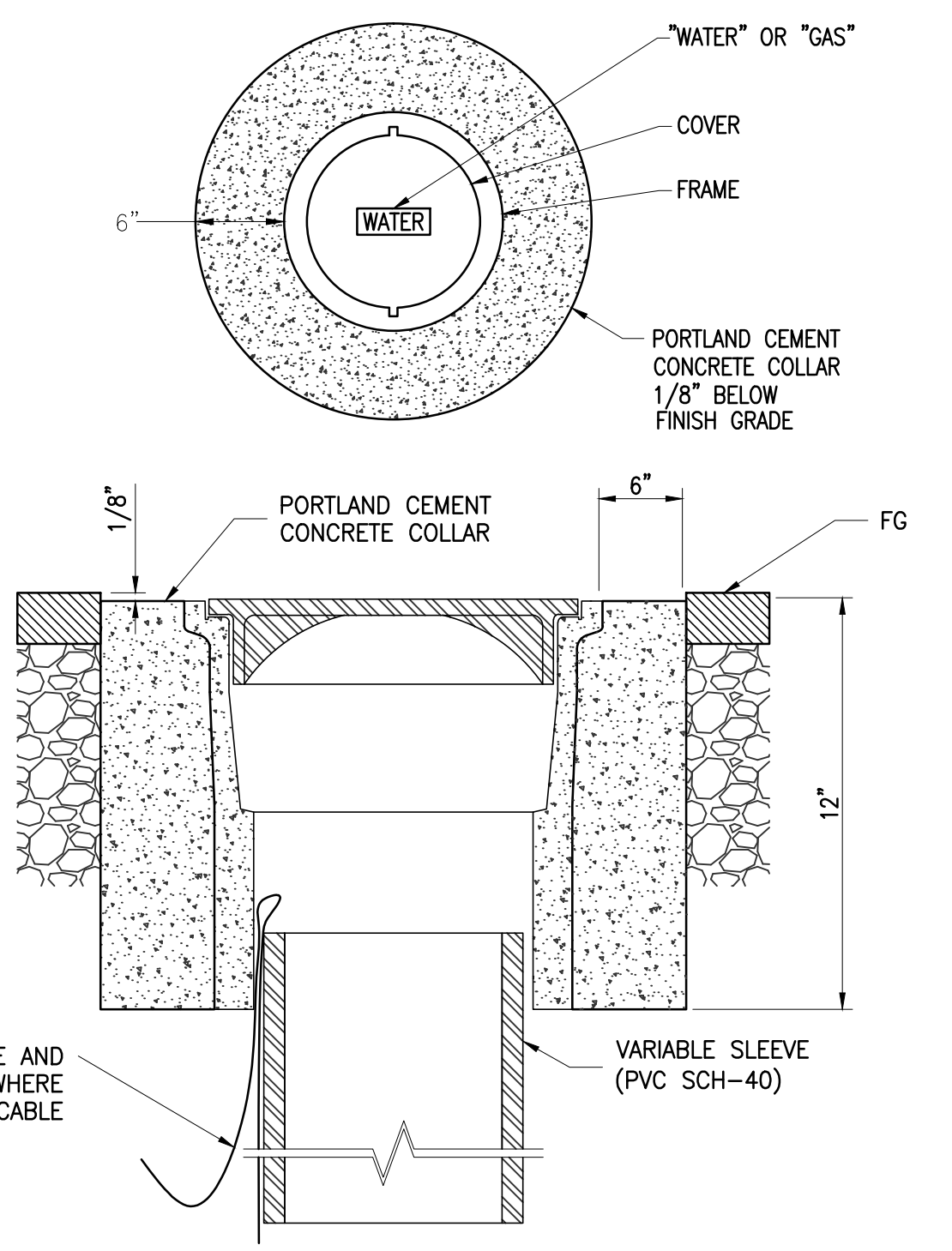

8
D1
VALVE BOX ADJUSTMENT DETAIL
N.T.S.

- NOTES:
- VALVE BOX AND COVER TO CONFORM TO SPECIAL PROVISIONS.
 - VALVE BOX LID SHALL BE OILED PRIOR TO PAVING OR CLEANING TO ENSURE THAT LID MARKINGS ARE LEGIBLE.
 - INSTALL VALVE BOX LID TO BE FLUSH WITH CONCRETE COLLAR AND 1/8" BELOW FINISH GRADE.
 - WHERE TRACER WIRES ARE SPliced USE WATER TIGHT CONNECTION.
 - USE OF GRADE RINGS PROHIBITED.



2015 STREET REHABILITATION PROJECT

OWNER



**420 CAPITOLA AVENUE
CAPITOLA, CA 95010**

NO.	DATE	DESCRIPTION
	06/23/2015	ISSUED FOR CONSTRUCTION

PROJECT NO:	303.05.55
DESIGNED BY:	JB
DRAWN BY:	AP
CHECKED BY:	FGH DATE: 06/12/2015
DATE:	06/23/2015

This drawing is the property of NCE, including all patented and patentable features, and/or confidential information and its use is conditioned upon the user's agreement not to reproduce the drawing, in whole or part, nor the material described thereon, nor the use of the drawing for any purpose other than specifically permitted in writing by NCE.

SHEET TITLE

CONSTRUCTION DETAILS AND SECTIONS

DRAWING
D1

