

This document, together with the concept and design presented herein, is an instrument of service, is intended only for the specific purpose and client for which it was prepared, issued and adopted by Kimley-Horn and Associates, Inc. shall be without liability to Kimley-Horn and Associates, Inc.

PROJECT DESCRIPTION

INSTALL PAVEMENT MARKINGS AND GREEN THERMOPLASTIC FOR BIKE LANE ENHANCEMENT ON A PORTION OF 41ST AVENUE, BAY AVENUE, AND PARK AVENUE BETWEEN THE STATE ROUTE 1 INTERCHANGE RAMP. IMPROVEMENTS WILL INCLUDE RE-STRIPING OF EXISTING CLASS II BIKE FACILITIES.

CONTACTS

- 1. CIVIL ENGINEER KIMLEY-HORN AND ASSOCIATES, INC.
100 WEST SAN FERNANDO STREET, SUITE 250
SAN JOSE, CA 95113
TEL: 669-800-4130
CONTACT: DEREK WU

- 2. CITY ENGINEER CITY OF CAPITOLA PUBLIC WORKS DEPARTMENT
420 CAPITOLA AVE.
CAPITOLA, CA 95010
TEL: (831) 475-7300
CONTACT: STEVE JESBERG

HIGHWAY 1 ENHANCED BIKE LANE IMPROVEMENT PROJECT

SANTA CRUZ COUNTY CAPITOLA, CALIFORNIA

TO BE SUPPLEMENTED BY THE CALTRANS STANDARD PLANS 2015
AND CALIFORNIA MUTCD DATED JANUARY 2014

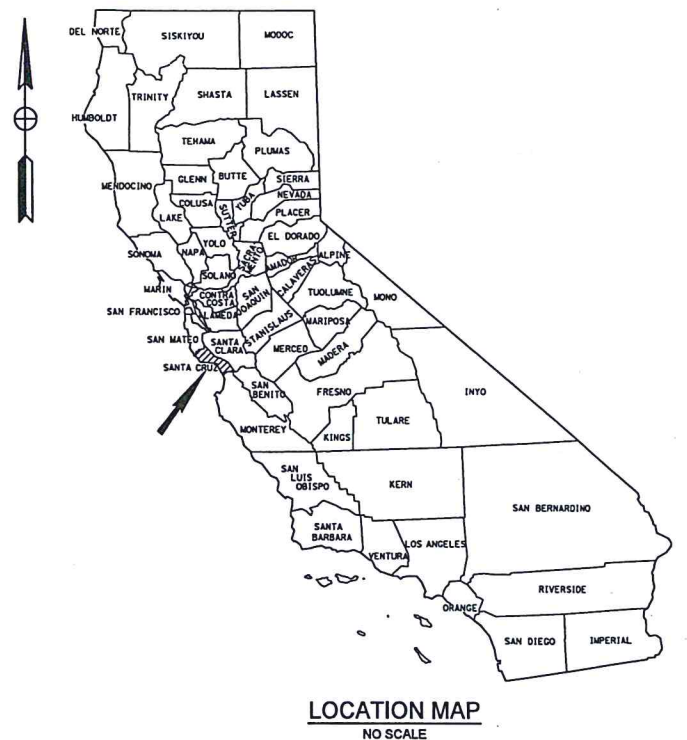
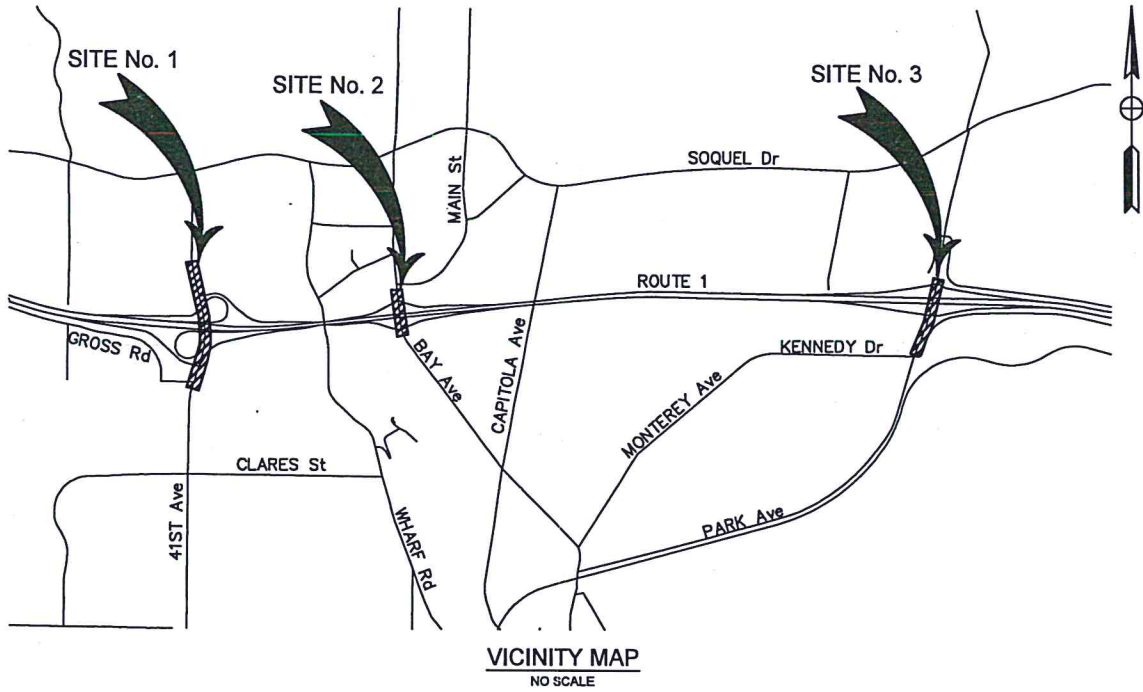

REFERENCES

- 1. 2015 CALTRANS STANDARD PLANS AND SPECIFICATIONS
- 2. 2015 CALTRANS HIGHWAY DESIGN MANUAL 6TH EDITION
- 3. 2014 CALIFORNIA MANUAL ON UNIFORM TRAFFIC CONTROL DEVICES

ACCEPTANCE OF PLANS

THE CITY OF CAPITOLA HEREBY ACCEPTS THESE PLANS FOR CONSTRUCTION, AS BEING IN GENERAL COMPLIANCE WITH PLANS PREPARATION REQUIREMENTS OF THIS GOVERNMENT. RESPONSIBILITY FOR THE COMPLETENESS AND ACCURACY OF THE PLANS AND RELATED DESIGN RESIDES WITH THE ENGINEER AND ENGINEERING FIRM OF RECORD.

Steve Jesberg

 DATE 1-10-2017
 STEVE JESBERG P.E. DATE
 DIRECTOR OF PUBLIC WORKS/CITY ENGINEER
 CITY OF CAPITOLA

SHEET INDEX	
No	TITLE
CV-01	COVER SHEET
SS-01 TO SS-04	SIGNING AND PAVEMENT DELINEATION PLANS
TC-01	TRAFFIC CONTROL DETAILS

CALTRANS District 5 Permit Plans

Permit No. 0516-NMC-0124

Plan No. _____

Page 1 of 6

<p style="font-size: 8px;">© 2015 KIMLEY-HORN AND ASSOCIATES, INC. 100 WEST SAN FERNANDO STREET, SUITE 250, SAN JOSE, CA 95113 PHONE: 669-800-4130 WWW.KIMLEY-HORN.COM</p>	KHA PROJECT 097763122 DATE 09/26/2016 SCALE AS SHOWN DESIGNED BY DW DRAWN BY DW CHECKED BY DC	<h3 style="margin: 0;">HIGHWAY 1 ENHANCED BIKE LANE IMPROVEMENTS</h3> <p style="margin: 0;">PREPARED FOR CITY OF CAPITOLA</p> <p style="margin: 0;">SANTA CRUZ COUNTY CA</p>		<h2 style="margin: 0;">COVER SHEET</h2>	SHEET NO. <u>1</u> OF <u>6</u> SHEETS CV-01
--	--	---	--	---	--

CALTRANS District 5 Permit Plans

Permit No. 0516-MMC-0124

Plan No. _____

Page 2 of 6

LEGEND:

- BIKE LANE (GREEN THERMOPLASTIC)
- PROPOSED SIGN
- STRIPING DETAIL (SEE SHEET SS-04)
- CALTRANS STRIPING DETAIL (SEE CALTRANS REVISED STANDARD PLANS)
- EXISTING CALTRANS STRIPING DETAIL (SEE CALTRANS REVISED STANDARD PLANS)
- STRIPING CHANGE
- STRIPING LIMIT
- ANGLE POINT
- PROPOSED SHARROW MARKING
- EXISTING TYPE I 10' ARROW
- EXISTING TYPE I 24' ARROW
- EXISTING TYPE II (L/R) ARROW
- EXISTING TYPE II (B) ARROW
- EXISTING TYPE III (L/R) ARROW
- EXISTING 'BIKE LANE' MARKING
- EXISTING 'BIKE LANE' MARKING
- EXISTING 'AHEAD' MARKING
- EXISTING 'CLEAR' MARKING
- EXISTING 'KEEP' MARKING
- EXISTING 'SIGNAL' MARKING
- EXISTING 'STOP' MARKING
- EXISTING 1' WHITE CROSSWALK AND LIMIT LINE

GENERAL NOTES:

1. ALL EXISTING SIGNS SHALL BE PROTECTED IN PLACE UNLESS SPECIFIED FOR REMOVAL OR RELOCATION.
2. ALL EXISTING STRIPING CONFLICTING WITH PROPOSED STRIPING SHALL BE REMOVED BY GRINDING PRIOR TO NEW STRIPING INSTALLATION.
3. ROADWAY ALIGNMENT SHOWN FOR PAVEMENT DELINEATION STATIONING GENERATED WITHOUT EXISTING MONUMENT OR BENCHMARK BASIS. ENGINEER ON SITE SHALL VERIFY STRIPING LOCATION PRIOR TO INSTALLATION.
4. ALL STRIPING DIMENSIONS SHOWN ARE MEASURED FROM STRIPE TO STRIPE, STRIPE TO LIP OF GUTTER, OR STRIPE TO FACE OF CURB WHICHEVER IS SCENARIO IS CLOSER.
5. CLASS II BIKEWAY AND LANE DIMENSIONS SHALL CONFORM TO THE STANDARDS IN THE 2015 HIGHWAY DESIGN MANUAL SECTION 301.2 AND SHALL GOVERN OVER STRIPING SHOWN ON PLANS.
6. PER THE HIGHWAY DESIGN MANUAL, THE MINIMUM CLASS II BIKE LANE WIDTH SHALL BE 4 FEET EXCEPT WHERE ON HIGHWAYS WITH CONCRETE CURB AND GUTTER, A MINIMUM WIDTH OF 3 FEET MEASURED FROM THE BIKE LANE STRIPE TO THE JOINT BETWEEN THE SHOULDER PAVEMENT AND THE GUTTER SHALL BE PROVIDED.



GRAPHIC SCALE



(IN FEET)
1 inch = 40 ft.

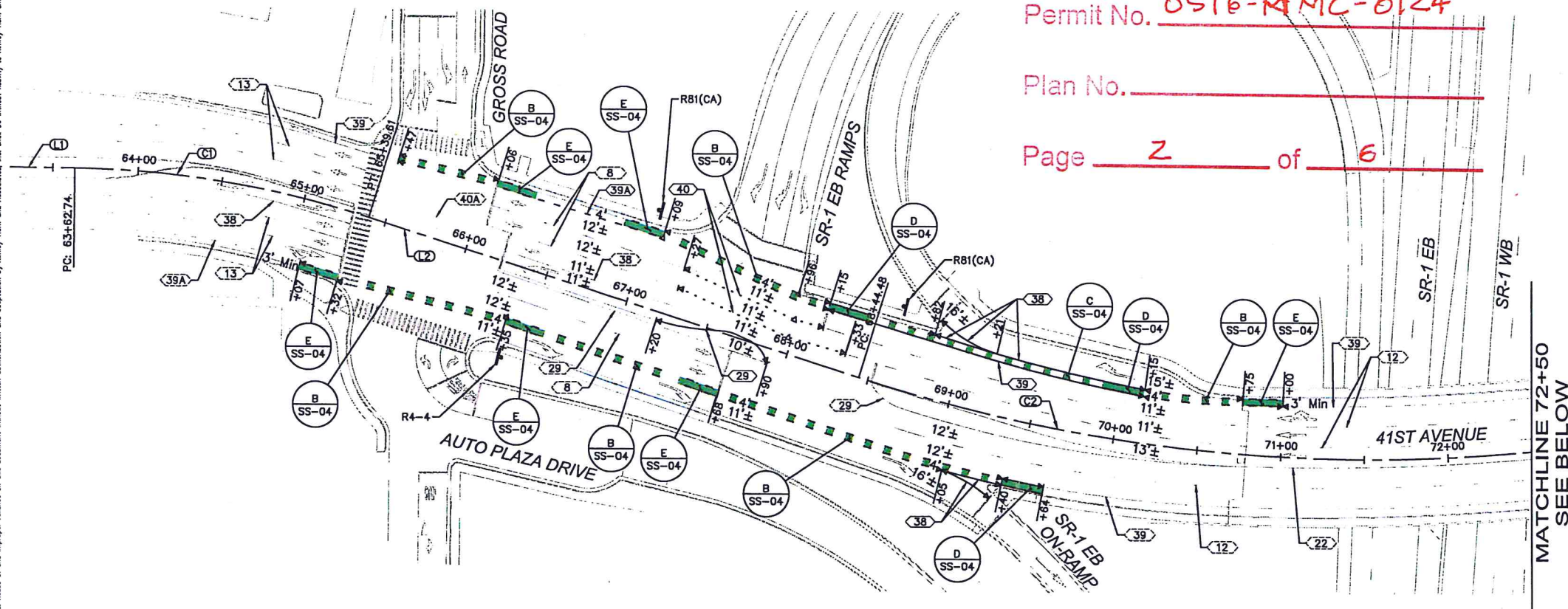

MATCHLINE 72+50
SEE BELOW

CURVE TABLE						
CURVE	RADIUS	LENGTH	CHORD BEARING	CHORD	DELTA	TANGENT
C1	600.00'	176.87'	N9°07'01"E	176.23'	16°53'23"	89.08'
C2	1000.00'	572.83'	N1°09'05"E	565.03'	32°49'14"	294.51'

LINE TABLE		
LINE	LENGTH	BEARING
L1	362.74	N0°40'19.03"E
L2	304.87	N17°33'42.26"E
L3	109.88	N15°15'31.40"W
L4	337.99	N10°34'16.39"W

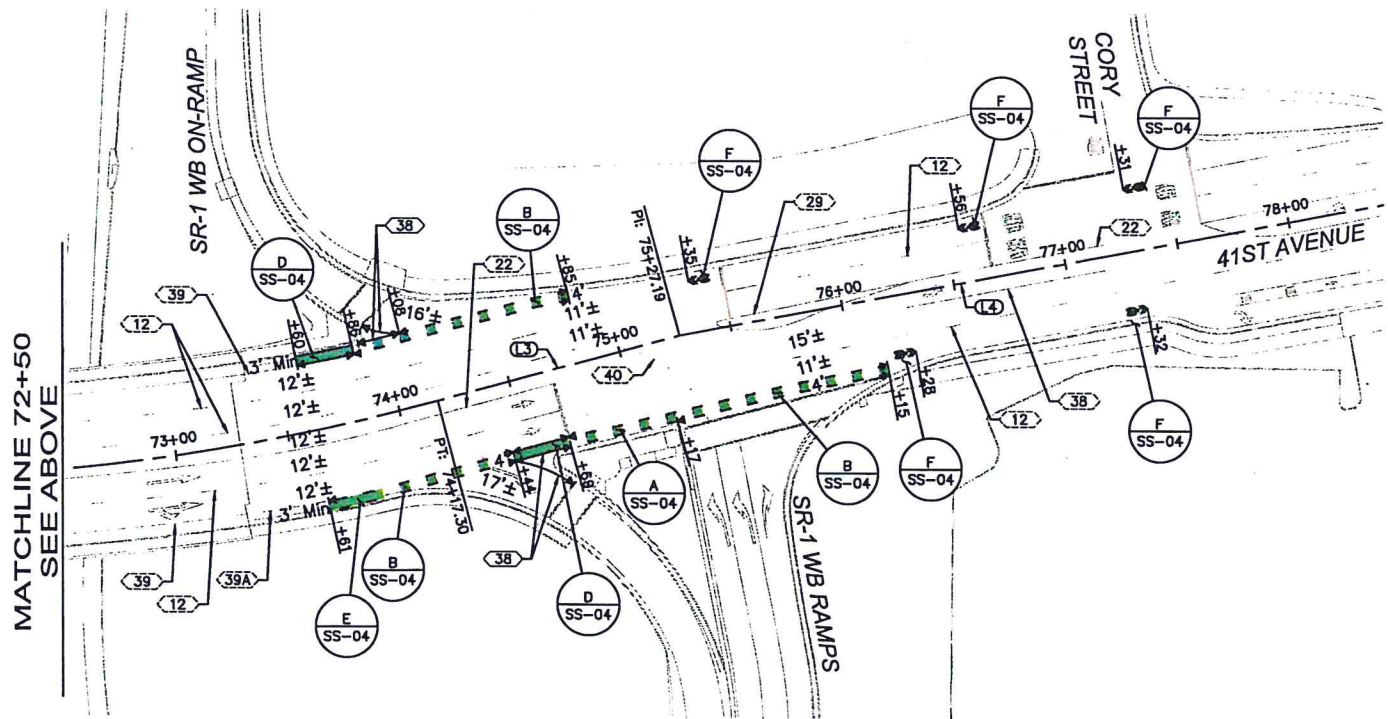

MATCHLINE 72+50
SEE ABOVE

THIS PLAN ACCURATE FOR SIGNING AND STRIPING ONLY

No.	REVISIONS	DATE	BY

Kimley Horn
 © 2015 KIMLEY-HORN AND ASSOCIATES, INC.
 100 WEST SAN FERNANDO STREET, SUITE 250, SAN JOSE, CA 95113
 PHONE: 669-800-4130
 WWW.KIMLEY-HORN.COM

KHA PROJECT
097763122
 DATE
09/26/2016
 SCALE AS SHOWN
 DESIGNED BY DW
 DRAWN BY DW
 CHECKED BY DC

HIGHWAY 1 ENHANCED BIKE LANE IMPROVEMENTS
 PREPARED FOR
CITY OF CAPITOLA
 SANTA CRUZ COUNTY
 CA

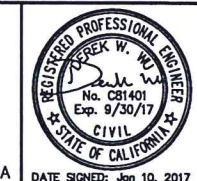

SIGNING AND PAVEMENT DELINEATION PLANS
 SITE No 1

SHEET NO. 2
 OF 6 SHEETS
SS-01

This document, together with the concepts and designs presented herein, is intended only for the specific purpose and client for which it was prepared. Reuse of and improper reliance on this document without written authorization and completion by Kimley-Horn and Associates, Inc. and be without liability to Kimley-Horn and Associates, Inc.

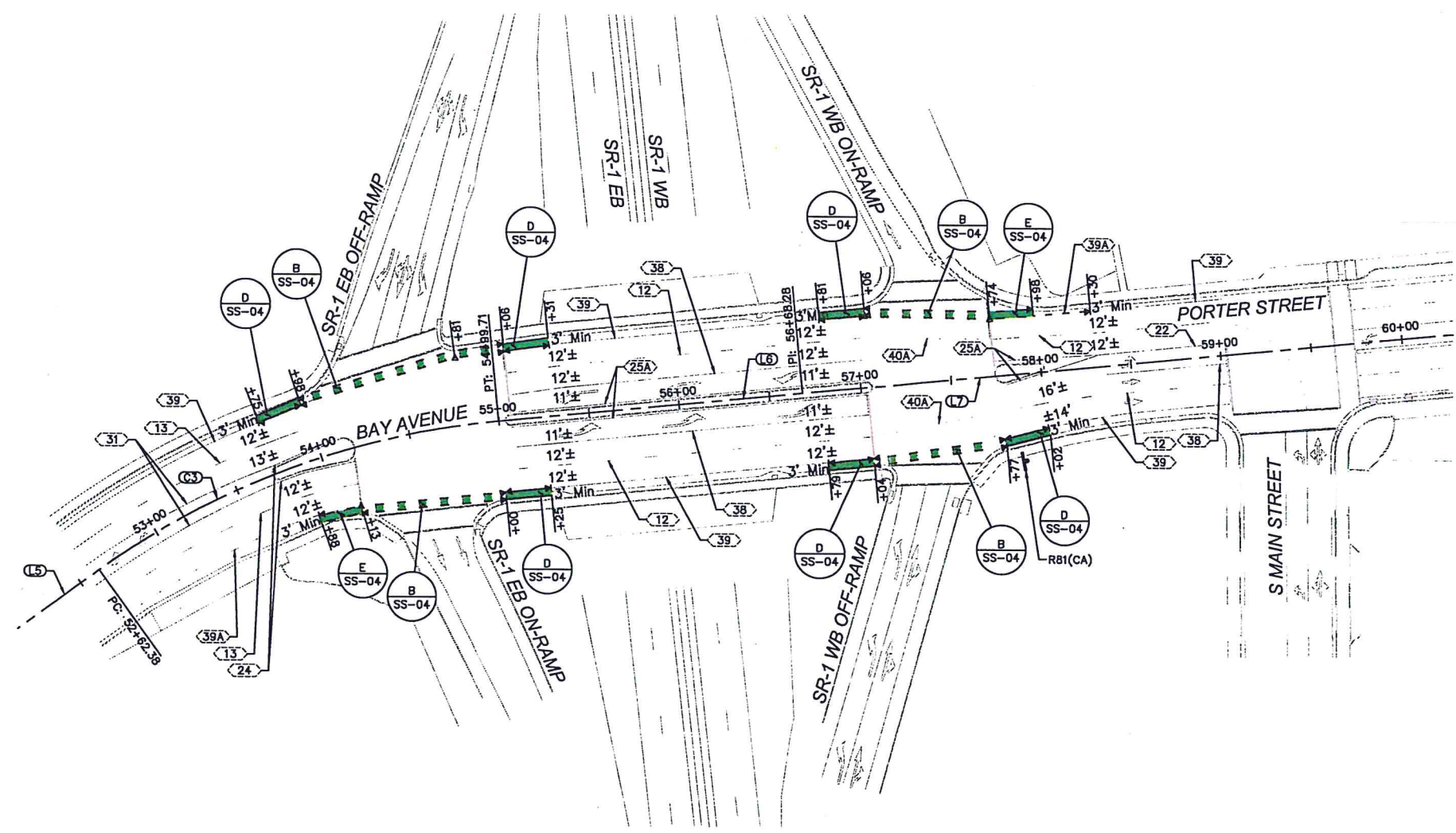

- LEGEND:**
- BIKE LANE (GREEN THERMOPLASTIC)
 - PROPOSED SIGN
 - XX STRIPING DETAIL (SEE SHEET SS-04)
 - XX CALTRANS STRIPING DETAIL (SEE CALTRANS REVISED STANDARD PLANS)
 - XX EXISTING CALTRANS STRIPING DETAIL (SEE CALTRANS REVISED STANDARD PLANS)
 - STRIPING CHANGE
 - STRIPING LIMIT
 - ANGLE POINT
 - PROPOSED SHARROW MARKING
 - EXISTING TYPE I 10' ARROW
 - EXISTING TYPE I 24' ARROW
 - EXISTING TYPE II (L/R) ARROW
 - EXISTING TYPE III (B) ARROW
 - EXISTING TYPE III (L/R) ARROW
 - EXISTING 'BIKE LANE' MARKING
 - EXISTING 'BIKE LANE' MARKING
 - EXISTING 'AHEAD' MARKING
 - EXISTING 'CLEAR' MARKING
 - EXISTING 'KEEP' MARKING
 - EXISTING 'SIGNAL' MARKING
 - EXISTING 'STOP' MARKING
 - EXISTING 1' WHITE CROSSWALK AND LIMIT LINE

- GENERAL NOTES:**
1. ALL EXISTING SIGNS SHALL BE PROTECTED IN PLACE UNLESS SPECIFIED FOR REMOVAL OR RELOCATION.
 2. ALL EXISTING STRIPING CONFLICTING WITH PROPOSED STRIPING SHALL BE REMOVED BY GRINDING PRIOR TO NEW STRIPING INSTALLATION.
 3. ROADWAY ALIGNMENT SHOWN FOR PAVEMENT DELINEATION STATIONING GENERATED WITHOUT EXISTING MONUMENT OR BENCHMARK BASIS. ENGINEER ON SITE SHALL VERIFY STRIPING LOCATION PRIOR TO INSTALLATION.
 4. ALL STRIPING DIMENSIONS SHOWN ARE MEASURED FROM STRIPE TO STRIPE, STRIPE TO LIP OF GUTTER, OR STRIPE TO FACE OF CURB WHICHEVER IS SCENARIO IS CLOSER.
 5. CLASS II BIKEWAY AND LANE DIMENSIONS SHALL CONFORM TO THE STANDARDS IN THE 2015 HIGHWAY DESIGN MANUAL SECTION 301.2 AND SHALL GOVERN OVER STRIPING SHOWN ON PLANS.
 6. PER THE HIGHWAY DESIGN MANUAL, THE MINIMUM CLASS II BIKE LANE WIDTH SHALL BE 4 FEET EXCEPT WHERE ON HIGHWAYS WITH CONCRETE CURB AND GUTTER, A MINIMUM WIDTH OF 3 FEET MEASURED FROM THE BIKE LANE STRIPE TO THE JOINT BETWEEN THE SHOULDER PAVEMENT AND THE GUTTER SHALL BE PROVIDED.

CURVE TABLE						
CURVE	RADIUS	LENGTH	CHORD BEARING	CHORD	DELTA	TANGENT
C3	450.00'	237.33'	N20°38'47"W	234.59'	30°13'05"	121.50'

LINE TABLE		
LINE	LENGTH	BEARING
L5	262.38	N35°45'19.71"W
L6	168.56	N5°32'14.56"W
L7	393.32	N5°23'13.38"W

CALTRANS District 5 Permit Plans

Permit No. 0516-NMC-0124

Plan No. _____

Page 3 of 6

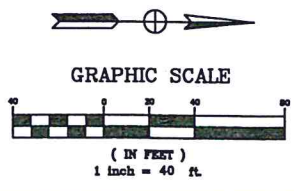

THIS PLAN ACCURATE FOR SIGNING AND STRIPING ONLY

	<p>© 2015 KIMLEY-HORN AND ASSOCIATES, INC. 100 WEST SAN FERNANDO STREET, SUITE 250, SAN JOSE, CA 95113 PHONE: 669-800-4130 WWW.KIMLEY-HORN.COM</p>	<p>KHA PROJECT 097763122</p> <p>DATE 09/26/2016</p> <p>SCALE AS SHOWN</p> <p>DESIGNED BY DW</p> <p>DRAWN BY DW</p> <p>CHECKED BY DC</p>	<p>HIGHWAY 1 ENHANCED BIKE LANE IMPROVEMENTS</p> <p>PREPARED FOR CITY OF CAPITOLA</p> <p>SANTA CRUZ COUNTY CA</p>	<p>DATE SIGNED: Jan 10, 2017</p>	<p>SIGNING AND PAVEMENT DELINEATION PLANS</p> <p>SITE No 2</p>	<p>SHEET NO. <u>3</u> OF <u>6</u> SHEETS</p> <p>SS-02</p>																
<table border="1" style="width: 100%; border-collapse: collapse;"> <thead> <tr> <th>No.</th> <th>REVISIONS</th> <th>DATE</th> <th>BY</th> </tr> </thead> <tbody> <tr><td> </td><td> </td><td> </td><td> </td></tr> <tr><td> </td><td> </td><td> </td><td> </td></tr> <tr><td> </td><td> </td><td> </td><td> </td></tr> </tbody> </table>	No.	REVISIONS	DATE	BY																		
No.	REVISIONS	DATE	BY																			

This document, together with the concepts and design presented herein, or an instrument of service, is intended only for the specific purpose and client for which it was prepared. Review of and improper reliance on this document without written authorization and adaptation by Kimley-Horn and Associates, Inc. and be without liability to Kimley-Horn and Associates, Inc.

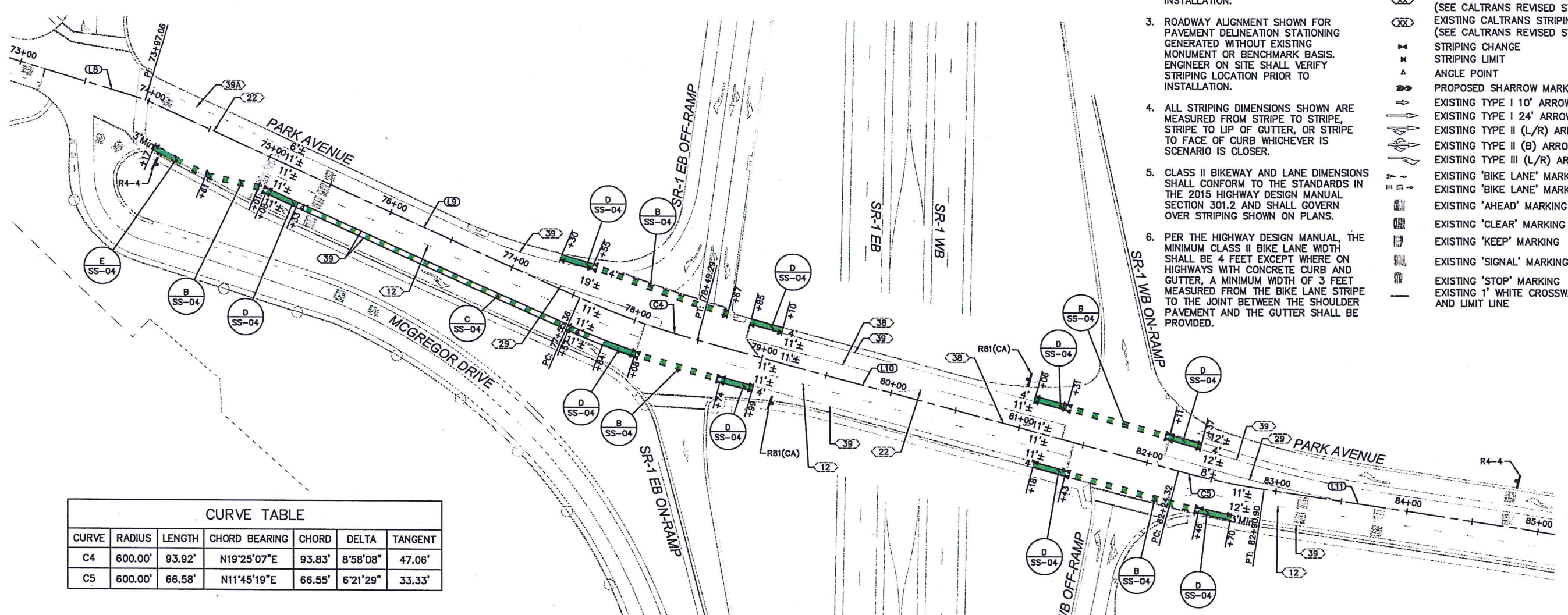

GENERAL NOTES:

1. ALL EXISTING SIGNS SHALL BE PROTECTED IN PLACE UNLESS SPECIFIED FOR REMOVAL OR RELOCATION.
2. ALL EXISTING STRIPING CONFLICTING WITH PROPOSED STRIPING SHALL BE REMOVED BY GRINDING PRIOR TO NEW STRIPING INSTALLATION.
3. ROADWAY ALIGNMENT SHOWN FOR PAVEMENT DELINEATION STATIONING GENERATED WITHOUT EXISTING MONUMENT OR BENCHMARK BASIS. ENGINEER ON SITE SHALL VERIFY STRIPING LOCATION PRIOR TO INSTALLATION.
4. ALL STRIPING DIMENSIONS SHOWN ARE MEASURED FROM STRIPE TO STRIPE, STRIPE TO LIP OF GUTTER, OR STRIPE TO FACE OF CURB WHICHEVER IS SCENARIO IS CLOSER.
5. CLASS II BIKEWAY AND LANE DIMENSIONS SHALL CONFORM TO THE STANDARDS IN THE 2015 HIGHWAY DESIGN MANUAL SECTION 301.2 AND SHALL GOVERN OVER STRIPING SHOWN ON PLANS.
6. PER THE HIGHWAY DESIGN MANUAL, THE MINIMUM CLASS II BIKE LANE WIDTH SHALL BE 4 FEET EXCEPT WHERE ON HIGHWAYS WITH CONCRETE CURB AND GUTTER, A MINIMUM WIDTH OF 3 FEET MEASURED FROM THE BIKE LANE STRIPE TO THE JOINT BETWEEN THE SHOULDER PAVEMENT AND THE GUTTER SHALL BE PROVIDED.

LEGEND:

- BIKE LANE (GREEN THERMOPLASTIC)
- PROPOSED SIGN
- STRIPING DETAIL (SEE SHEET SS-04)
- CALTRANS STRIPING DETAIL (SEE CALTRANS REVISED STANDARD PLANS)
- EXISTING CALTRANS STRIPING DETAIL (SEE CALTRANS REVISED STANDARD PLANS)
- STRIPING CHANGE
- STRIPING LIMIT
- ANGLE POINT
- PROPOSED SHARROW MARKING
- EXISTING TYPE I 10' ARROW
- EXISTING TYPE I 24' ARROW
- EXISTING TYPE II (L/R) ARROW
- EXISTING TYPE II (B) ARROW
- EXISTING TYPE III (L/R) ARROW
- EXISTING 'BIKE LANE' MARKING
- EXISTING 'BIKE LANE' MARKING
- EXISTING 'AHEAD' MARKING
- EXISTING 'CLEAR' MARKING
- EXISTING 'KEEP' MARKING
- EXISTING 'SIGNAL' MARKING
- EXISTING 'STOP' MARKING
- EXISTING 1' WHITE CROSSWALK AND LIMIT LINE

CURVE	RADIUS	LENGTH	CHORD BEARING	CHORD	DELTA	TANGENT
C4	600.00'	93.92'	N19°25'07"E	93.83'	8°58'08"	47.06'
C5	600.00'	66.58'	N11°45'19"E	66.55'	6°21'29"	33.33'

LINE	LENGTH	BEARING
L8	397.06	N16°49'32.64"E
L9	358.30	N23°54'11.14"E
L10	375.03	N14°56'03.24"E
L11	231.13	N8°34'34.06"E

CALTRANS District 5 Permit Plans

Permit No. 0516-NMC-0124

Plan No. _____

Page 4 of 6

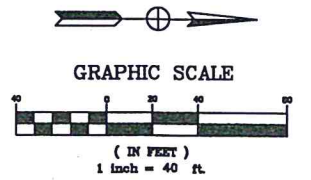

THIS PLAN ACCURATE FOR SIGNING AND STRIPING ONLY

No.	REVISIONS	DATE	BY

Kimley-Horn
© 2015 KIMLEY-HORN AND ASSOCIATES, INC.
100 WEST SAN FERNANDO STREET, SUITE 250, SAN JOSE, CA 95113
PHONE: 669-800-4130
WWW.KIMLEY-HORN.COM

KHA PROJECT
097763122
DATE
09/26/2016
SCALE AS SHOWN
DESIGNED BY DW
DRAWN BY DW
CHECKED BY DC

HIGHWAY 1 ENHANCED BIKE LANE IMPROVEMENTS
PREPARED FOR
CITY OF CAPITOLA
SANTA CRUZ COUNTY
CA



SIGNING AND PAVEMENT DELINEATION PLANS
SITE No 3

SHEET NO. 4
OF 6 SHEETS
SS-03

This document, together with the concepts and designs presented herein, is intended only for the specific purpose and client for which it was prepared. Release of and improper reliance on this document without written authorization and approval by Kimley-Horn and Associates, Inc. shall be without liability to Kimley-Horn and Associates, Inc.

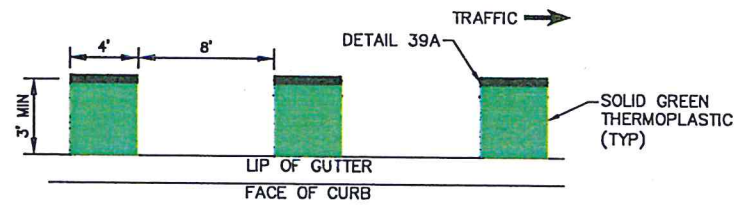

A THERMOPLASTIC PAVEMENT MARKING (GREEN) FOR BIKE LANES ADJACENT TO GUTTER PAN
SS-04 NO SCALE

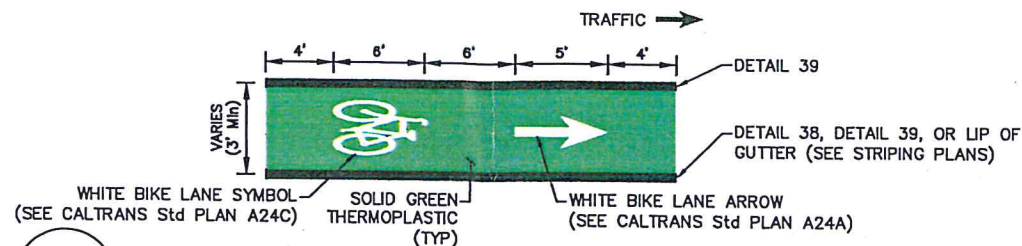

D THERMOPLASTIC PAVEMENT MARKING (GREEN) FOR BIKE LANES BIKE LANE SYMBOL AND ARROW
SS-04 NO SCALE

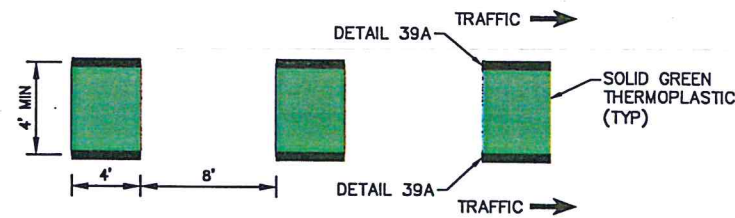

B THERMOPLASTIC PAVEMENT MARKING (GREEN) FOR BIKE LANES DASHED STRIPE
SS-04 NO SCALE

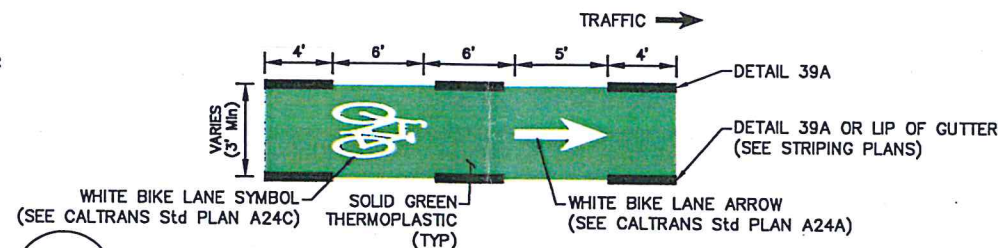

E THERMOPLASTIC PAVEMENT MARKING (GREEN) FOR BIKE LANES BIKE LANE SYMBOL AND ARROW
SS-04 NO SCALE

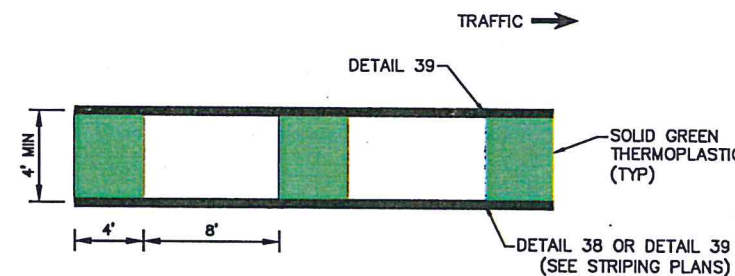

C THERMOPLASTIC PAVEMENT MARKING (GREEN) FOR BIKE LANES SOLID STRIPE
SS-04 NO SCALE

*FOR ADDITIONAL DETAILS, SEE CALTRANS Std PLAN A24C.

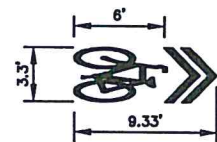

F PAVEMENT MARKING FOR BIKE LANES SHARED LANE MARKING
SS-04 NO SCALE

STRIPING SCHEDULE					
DETAIL	PATTERN OR LEGEND	SITE No 1 (LF)	SITE No 2 (LF)	SITE No 3 (LF)	TOTAL
29	MEDIAN ISLAND	75	0	0	75
38	CHANNELIZING LINE	299	0	0	299
39	BIKE LANE LINE	398	150	854	1402
39A	INTERSECTION LINE (BIKE LANE LINE)	1866	783	855	3504
40	LANE LINE EXTENSIONS THROUGH INTERSECTIONS	196	0	0	196
TOTAL		2834	933	1709	

PAVEMENT MARKING SCHEDULE				
PATTERN OR LEGEND	SITE No 1 (SF)	SITE No 2 (SF)	SITE No 3 (SF)	TOTAL
SHARROW	60	0	0	60
BIKE LANE SYMBOL WITH ARROW	168	112	140	420
GREEN PAINT FOR BIKE LANES	2448	1200	1912	5560
TOTAL	2676	1312	2052	

*NOTE: ALL STRIPING AND PAVEMENT MARKINGS SHOULD BE THERMOPLASTIC UNLESS OTHERWISE NOTED

SIGN SCHEDULE					
SIGN CODE	DESCRIPTION	SITE No 1 (EA)	SITE No 2 (EA)	SITE No 3 (EA)	TOTAL
R4-4	BEGIN RIGHT TURN LANE, YIELD TO BIKES	1	0	2	3
R81 (CA)	BIKE LANE	2	1	2	5
TOTAL		3	1	4	

GENERAL NOTES:

- ALL EXISTING SIGNS SHALL BE PROTECTED IN PLACE UNLESS SPECIFIED FOR REMOVAL OR RELOCATION.
- ALL EXISTING STRIPING CONFLICTING WITH PROPOSED STRIPING SHALL BE REMOVED BY GRINDING PRIOR TO NEW STRIPING INSTALLATION.
- ROADWAY ALIGNMENT SHOWN FOR PAVEMENT DELINEATION STATIONING GENERATED WITHOUT EXISTING MONUMENT OR BENCHMARK BASIS. ENGINEER ON SITE SHALL VERIFY STRIPING LOCATION PRIOR TO INSTALLATION.
- ALL STRIPING DIMENSIONS SHOWN ARE MEASURED FROM STRIPE TO STRIPE, STRIPE TO LIP OF GUTTER, OR STRIPE TO FACE OF CURB WHICHEVER IS SCENARIO IS CLOSER.
- CLASS II BIKEWAY AND LANE DIMENSIONS SHALL CONFORM TO THE STANDARDS IN THE 2015 HIGHWAY DESIGN MANUAL SECTION 301.2 AND SHALL GOVERN OVER STRIPING SHOWN ON PLANS.
- PER THE HIGHWAY DESIGN MANUAL, THE MINIMUM CLASS II BIKE LANE WIDTH SHALL BE 4 FEET EXCEPT WHERE ON HIGHWAYS WITH CONCRETE CURB AND GUTTER, A MINIMUM WIDTH OF 3 FEET MEASURED FROM THE BIKE LANE STRIPE TO THE JOINT BETWEEN THE SHOULDER PAVEMENT AND THE GUTTER SHALL BE PROVIDED.

CALTRANS District 5 Permit Plans

Permit No. 0516-NMC-0124

Plan No. _____

Page 5 of 6

THIS PLAN ACCURATE FOR SIGNING AND STRIPING ONLY

No.	REVISIONS	DATE	BY

Kimley»Horn
© 2015 KIMLEY-HORN AND ASSOCIATES, INC.
100 WEST SAN FERNANDO STREET, SUITE 250, SAN JOSE, CA 95113
PHONE: 869-800-4130
WWW.KIMLEY-HORN.COM

KHA PROJECT 097763122
DATE 09/26/2016
SCALE AS SHOWN
DESIGNED BY DW
DRAWN BY DW
CHECKED BY DC

HIGHWAY 1 ENHANCED BIKE LANE IMPROVEMENTS
PREPARED FOR
CITY OF CAPITOLA
SANTA CRUZ COUNTY

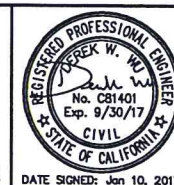

SIGNING AND PAVEMENT DELINEATION DETAILS

SHEET NO. 5
OF 6 SHEETS
SS-04

This document, together with the concepts and designs presented herein, is intended only for the specific purpose and client for which it was prepared. Reuse of and improper reliance on this document without written authorization and adaptation by Kimley-Horn and Associates, Inc. shall be without liability to Kimley-Horn and Associates, Inc.

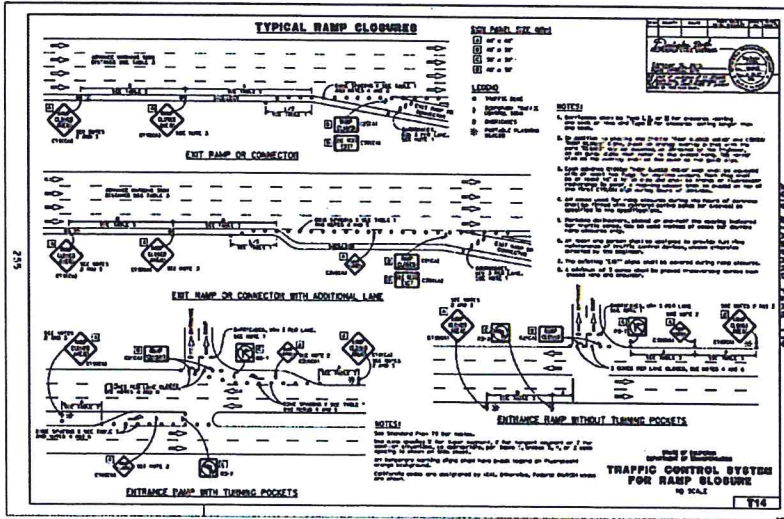
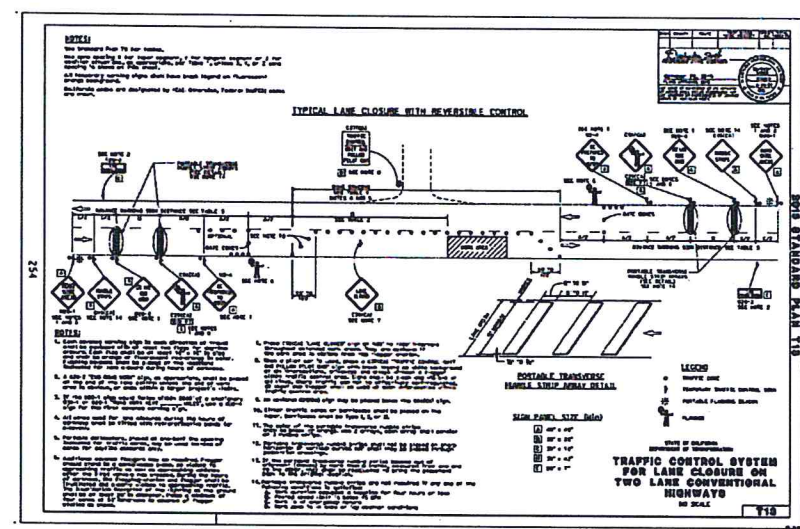
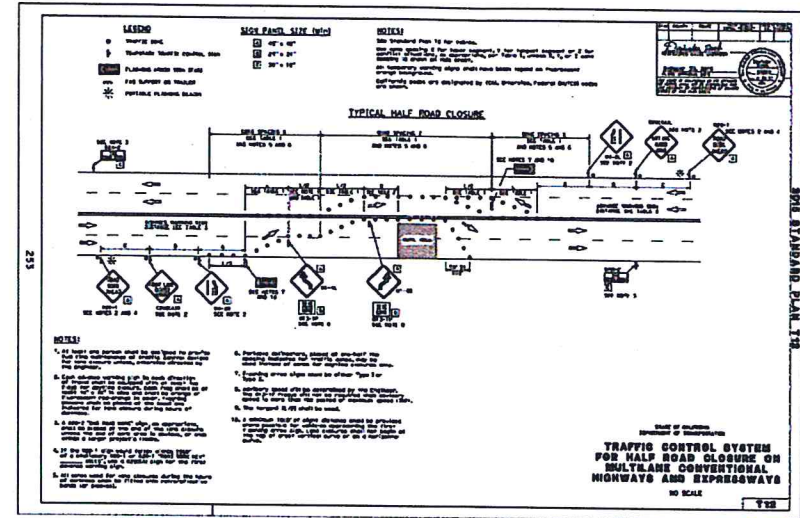
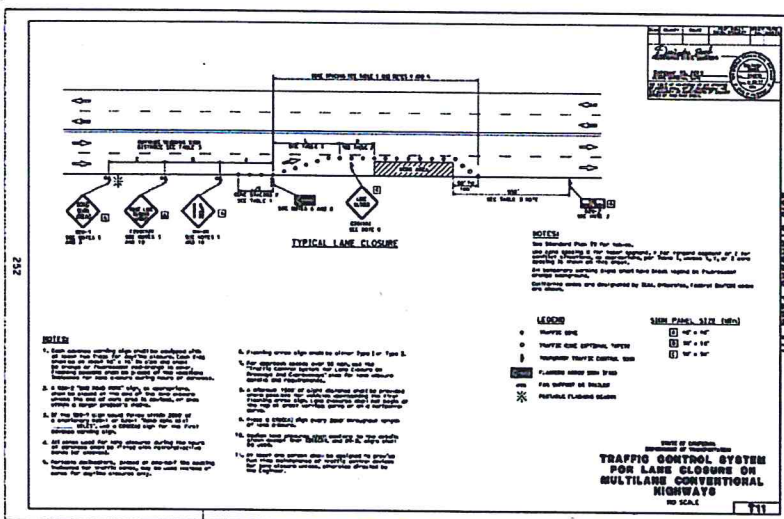
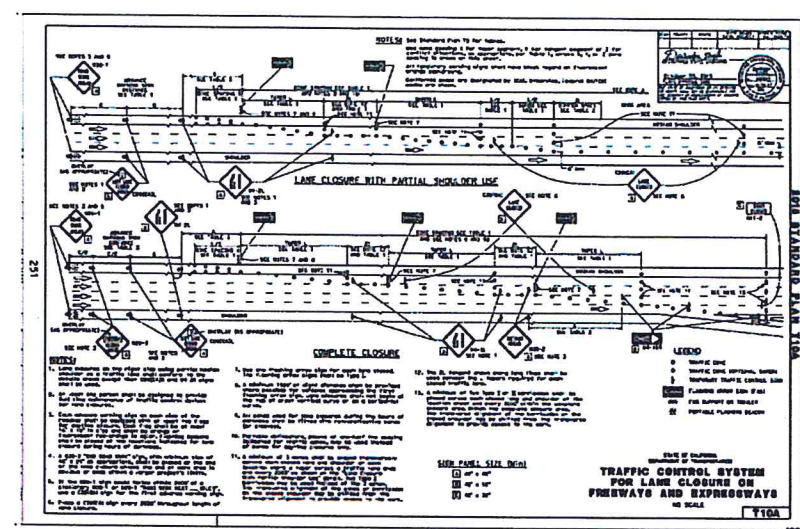
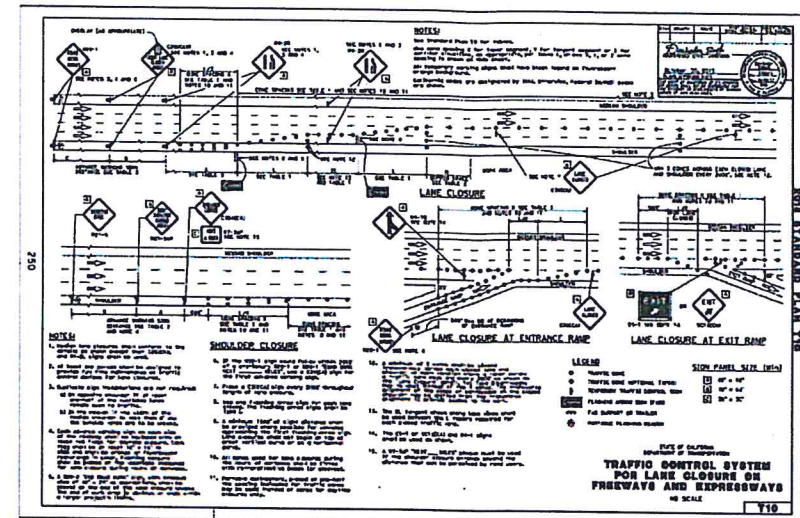
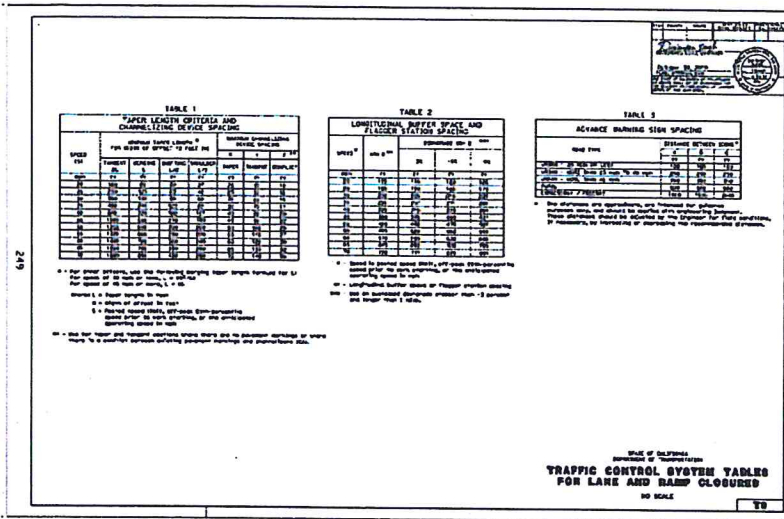

TRAFFIC CONTROL NOTES:

1. REFER TO CITY SPECIFICATIONS, 2014 CA MUTCD, AND CALTRANS 2015 STANDARD PLANS AND SPECIFICATIONS FOR TRAFFIC CONTROL SYSTEM.
2. THE CONTRACTOR SHALL INSTALL TRAFFIC CONTROL DEVICES PRIOR TO COMMENCEMENT OF CONSTRUCTION. THE CONTRACTOR SHALL ALSO MAINTAIN ALL TRAFFIC CONTROL DEVICES DURING CONSTRUCTION AS REQUIRED BY THE CITY ENGINEER/INSPECTOR. A 24-HOUR "ON-CALL" TELEPHONE NUMBER SHALL ALSO BE PROVIDED TO THE CITY BY THE CONTRACTOR FOR SERVICES REQUIRED BEYOND NORMAL WORKDAY OPERATIONS.
3. TEMPORARY TRAFFIC CONTROL SIGNS SHALL NOT BLOCK FIRE HYDRANTS AND/OR DRIVEWAYS.
4. ALL TRAFFIC CONTROL DEVICES (SIGNS, CHANNELIZERS, ETC.) SHALL BE RETROREFLECTIVE AND/OR ILLUMINATED DURING NIGHTTIME TRAFFIC CONTROL.
5. THE PARKING OF ANY CONSTRUCTION-RELATED VEHICLE OR STORAGE OF ANY MATERIAL IS NOT ALLOWED ON A PUBLIC STREET OR SIDEWALK UNLESS APPROVED IN ADVANCE BY THE CITY ENGINEER.
6. ANY TRAFFIC STRIPING, PAVEMENT MARKINGS, PAVEMENT SURFACE, ETC. DAMAGED OR DESTROYED BY CONTRACTOR'S WORK SHALL BE REPLACED BY CONTRACTOR TO THE SATISFACTION OF THE CITY ENGINEER AT CONTRACTOR'S SOLE EXPENSE.
7. OFF-RAMP CLOSURES REQUIRE A CHANGEABLE MESSAGE SIGN (CMS) ON MAINLINE SR-1 WARNING OF CLOSURE. PLACE CMS ±1000' IN ADVANCE OF PRECEDING EXIT. ADD APPROPRIATE SC6(CA) SIGNS SEVEN (7) DAYS PRIOR TO CLOSURE OF AFFECTED RAMPS.
8. RESTRICT LANE AND RAMP CLOSURE HOURS TO:
 - 9PM-7AM MONDAY-THURSDAY (NIGHTS)
 - 9AM-12PM SATURDAY-SUNDAY (DAYS)

CALTRANS District 5 Permit Plans

Permit No. 0516-NMC-0124

Plan No. _____

Page 6 of 6

No.	REVISIONS	DATE	BY

Kimley»Horn
 © 2015 KIMLEY-HORN AND ASSOCIATES, INC.
 100 WEST SAN FERNANDO STREET, SUITE 250, SAN JOSE, CA 95113
 PHONE: 669-500-4130
 WWW.KIMLEY-HORN.COM

KHA PROJECT 097763122
 DATE 09/26/2016
 SCALE AS SHOWN
 DESIGNED BY DW
 DRAWN BY DW
 CHECKED BY DC

HIGHWAY 1 ENHANCED BIKE LANE IMPROVEMENTS
 PREPARED FOR
CITY OF CAPITOLA
 SANTA CRUZ COUNTY
 CA

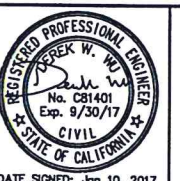

TRAFFIC CONTROL DETAILS

SHEET NO. 6
 OF 6 SHEETS

TC-01

DATE SIGNED: Jan 10, 2017